



ELECTRICITY



CABLE-SHEATH STRIPPERS

926

- Cable-sheath strippers 926
- Multifunction sheath strippers 928



WIRE STRIPPERS

929

- Automatic wire strippers 929
- Automatic lateral wire strippers 930
- End wire strippers 931



CRIMPING PLIERS

932

- Pre-insulated terminal crimping pliers 932
- Tubular terminal and sleeve crimping pliers 935
- Crimping dies 936
- Open core connector crimping pliers 937
- Wire end crimping pliers 937
- Transmission connectors crimping pliers 938
- Terminal sets 939



WIRING TOOLS

940

- Sleeving pliers 940
- Plastic cable-tie pliers 940
- Glue gun 941
- Cabinet keys 941



WIRE PULLER AND ACCESSORIES

942

- Nylon rods 942
- Glass fibre rods 943
- Nylon rods 943
- Accessories 943
- Consumables for nylon and glass fibre rods 944
- Accessories for nylon steel rods 944



HOLE PUNCHES

945

- Hole punches for ISO sizes 946
- Accessories 947



PHYSICAL MEASUREMENT

948

- Testers 948
- Thermometer 949



VE SERIES 1,000 VOLT INSULATED TOOLING

950

- Pliers 950
- Screwdrivers 954



VSE SERIES 1,000 VOLT INSULATED TOOLING

956

- Pliers 956
- Cable cutter 960
- Hacksaw frame 960
- Knife 961
- Wrenches 961
- Offset keys 962
- Box wrenches 962
- Sockets 1/4" 963
- Ratchets and accessories 1/4" 963
- Sockets 3/8" 964
- Bit sockets 3/8" 965
- Ratchets and accessories 3/8" 965
- Socket sets and accessories 3/8" 966
- Sockets 1/2" 966
- Bit sockets 1/2" 966
- Ratchets and accessories 1/2" 966
- Socket sets and accessories 1/2" 968
- Torque wrench 969
- Insulated gloves 969
- Insulated mats 970
- Insulated pliers 970
- Insulated tool sets 970



FLUO

RFID



CABLE-SHEATH STRIPPERS

MULTIFUNCTION SHEATH STRIPPER

Easy sheath stripping trigger for 30% less effort



PVC cables
Ø 4>28 mm

Pivoting blade for faster and easier sheath stripping



Easy blade change

- Easy blade change by pressing the release and locking point.



- 1 - Trigger system.
- 2 - Adjustment screw.
- 3 - Pivoting blade.
- 4 + 5 Double safety.
- 4 - Cutting blade out => trigger locked.
- 5 - Stop blade.
- 6 - Stripping point.
- 7 - Spare pivot blade.
- 8 - Pivot blade locking.
- 9 - Pivot blade release.

Ergonomic comfort grip handle



DOUBLE SAFETY
Cutting blade out
=> trigger locked. Stop blade.



▪ Multifunction trigger sheath-stripper



- Trigger system: 30% less effort.
- Self-swivelling blade: fast and easy sheath removal.
- Double safety:
 - Cutting blade out = trigger locked.
 - Lock back blade.
- Capacity: round PVC cable 4 to 28 mm diameter.
- Stripping zone.

872272: set of 6 spare blades (5 self-swivel blades and 1 knife blade).



872271

ΔΔ [g]
150

PIVOTING BLADE SHEATH STRIPPER



Jivaro

Extended hook for easy cable placing.



Easy, handy thumb wheel adjustment.



Ergonomic "low effort" push-button.

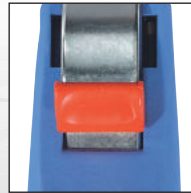

Rounded handle for a perfect grip.



Sheath strippers

- "Effort reducer" push button.
- Spare blade stored in the handle.
- Easily accessible adjustment knob.
- Self-swivel blade.
- 985955 straight blades.
- 985956 hooked blades.

986061: Set of 5 auto-swivel blades for sheath strippers 985951 - 985952 - 985953 - 985954 - 985955 - 985956.

Capacity Ø maxi [mm]	ΔΔ [g]	
985951	16	65
985952	28	65
985953	35	65
985954	50	65
985955	28 LD	75
985956	28 LC	75

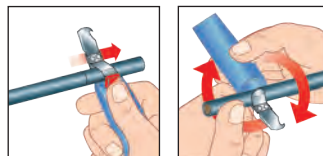

LONGITUDINAL/HELICOIDAL CABLE-SHEATH STRIPPER

Rotary sheath and insulation stripping tool

- Tool perfectly suited to stripping sheaths over long lengths.
- 2 possibilities of use:
 - Longitudinal sheath stripping.
 - Helicoidal sheath stripping by simple head rotation.
- Capacity: diameter 4.5 to 29 mm.

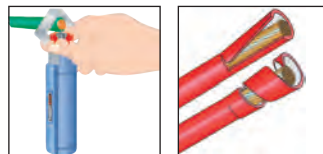

L [mm]	ΔΔ [g]	
985957	137	97

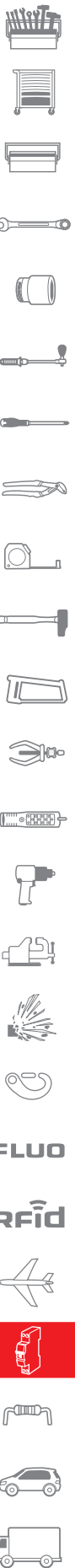

FLUO

RFid

MULTIFUNCTION SHEATH STRIPPERS

Multifunction sheath stripper

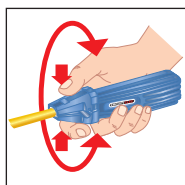
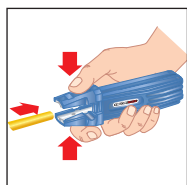

- Ideal for stripping sheaths on cables at the bottom of embedding boxes.
- Allows for stripping without prior adjustment.
- Also allows for stripping coax cables.
- Sheath stripping: diameter 4 to 13 mm.
- Stripping: section 0.5 to 16 mm².
- Coax cables: diameter 4 to 8 mm.



	$\Delta\Delta$ [g]
985962	90

Coax and multipair cable sheath stripper



- Tool facilitating sheath stripping of coax and twisted multipair (UTP and STP) cables and optical fibers.
- Capacity: diameter 11 mm.



	$\Delta\Delta$ [g]
985936	35

COAX CABLE-SHEATH STRIPPERS

Sheath and insulation stripper for coaxial and twisted-pair cables

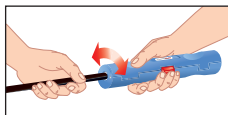
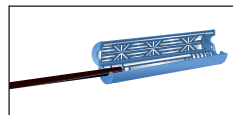

- 2 useful sides:
 - Sheath stripping.
 - Stripping.
- Capacity: diameter 4.8 to 7.5 mm.



	$\Delta\Delta$ [g]
985964	26

Strippers for coax cables types RG.58, RG.59 and RG.62

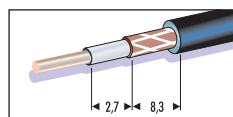

- Stripper pre-adjusted to strip coax cables in a single operation.
 - Stripping obtained allows direct fitting of BNC connectors used in computing, video, radio-telephony.
 - Compact, non adjustable without tool.
 - Reversible blade cassette doubling the time of use, supplied with calibration shim.
- 838.CX58L: Spare blade cassette.



	$\Delta\Delta$ [g]
838.CX58	75

AUTOMATIC WIRE STRIPPERS

AUTOMATIC WIRE STRIPPER



Swingo

The all-purpose stripper!

One tool for cutting and stripping wires from 0.02 to 10 mm².

- Adjustable stripping depth.
- Soft grips.
- Jaw force adjustment according to temperature conditions: indoor or outdoor working, hard or soft insulation.
- Mechanism designed for smooth, effortless wire stripping.
- Very easy blade change.

Tested to 150,000 cycles



■ **SWINGO® automatic stripper**

- 2 functions: cutting and stripping.
 - Play take-up mechanism for smooth and easy stripping.
 - Stripping capacity: 0.02 to 10 mm² (AWG: 32 - 8).
 - Stripping length adjusted from 3 to 18 mm.
 - Built-in cutting function:
 - Cutting up to: 1.5 mm² single strand wire.
 - Cutting up to: 10 mm² multi strand wire.
 - Ergonomic body in glass charged nylon.
- 793207: Spare jaw.
793910: Set of 2 spare pads.



	AWG	Cut	ΔΔ [g]
793936	32 - 8	10 mm ²	136

■ **SWINGO 90® automatic stripper and cutter**

- 2 functions: cutting and stripping.
 - Pistol grip for the optimum position for high volume stripping and cutting.
 - Stripping capacity: 0.02 to 10 mm² (AWG: 32 - 8).
 - Stripping length adjusted from 3 to 18 mm.
 - Built-in cutting function:
 - Cutting up to: 1.5 mm² single strand wire.
 - Cutting up to: 10 mm² multi strand wire.
 - Durable and lightweight for intense work, tested to over 150,000 cycles. Twice the strength of standard nylon/PA6.
- 793910: Set of 2 spare pads.



	ΔΔ [g]
793940	165,5



AUTOMATIC LATERAL WIRE STRIPPERS

Automatic lateral wire strippers

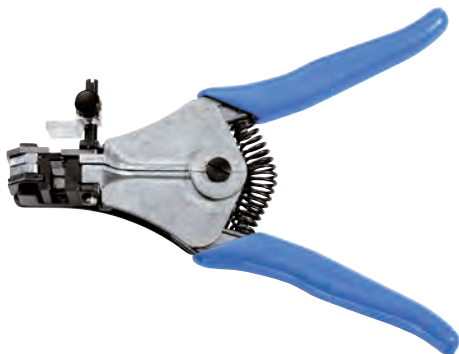

- These strippers offer high precision stripping with a diameter suited to each conductor.

175.E: Spare blade for 986058.

175.T: Spare blade for 986059.

	Pattern	Section [mm ²]	ΔΔ [g]
986058	∅ : 0,6 - 0,8 - 1,0 - 1,2 - 1,6 - 2,0 - 2,5 mm ²	1,5 -> 4,0	370
986059	∅ : 2,0 - 2,4 - 3,1 - 4,0 mm ²	2,4 -> 10,0	370

High precision strippers for Teflon insulators



- High precision to cut the insulator circularly without damaging the conductor.
- Offset jaws designed to avoid marking insulators.
- AWG: 26 - 24 - 22 - 20 - 18 - 16.
- Die diameter: 0.55 - 0.65 - 082 - 1.05 - 1.30 - 1.55 mm.
- 165.U: Spare knife.

	Dimension [mm]	ΔΔ [g]
165.1	250 x 75 x 22	370

AUTOMATIC WIRE CUTTERS-STRIPPERS

Automatic wire cutter-stripper



- For single or multiple strand with automatic adjustment to wire diameter.
- 1 tool only, 1 gesture for 2 operations:
 - Cutting.
 - Stripping.
- Stripping capacity: 0.4 to 4 mm²
- Stripping length adjusted by button: 4 to 17 mm.
- Cutting diameter: 0.7 to 2.3 mm.
- AWG: 21 - 11.
- 162-L1: Spare knives.

	L [mm]	AWG	Dimension [mm]	ΔΔ [g]
985761	160	21 - 11	290 x 80 x 22	340

Dual automatic wire cutter-stripper



- Allows to cut and strip the wire on both sides for fast wiring operations.
- The wire is pre-stripped automatically at the right length.
- Stripping capacity: 0.4 to 4 mm².
- Stripping length adjusted by button: 4 to 17 mm.
- Cutting diameter: 0.7 to 2.3 mm.
- AWG: 21 - 11.
- 162-2L1: Spare knives.

	L [mm]	AWG	ΔΔ [g]
985762	160	21 - 11	430

Wire cutter and stripper

- For multistrand cutting and stripping:
 - Diameter: 1.0 - 1.3 - 1.7 - 2.0 - 2.4 - 3.0 mm.
 - Section: 0.8 - 1.3 - 2.3 - 3.0 - 4.5 - 7.0 mm².
 - AWG: 20 - 18 - 16 - 14 - 12 - 10.
- 6 dies calibrated by grinding.
- End nipper.
- Return and lock spring.



Icon	L [mm]	ΔΔ [g]
163	150	115

END WIRE STRIPPERS

Extra-slim wire strippers

- For single and multistrand wires:
 - Max diameter: 1.5 mm.
 - Max section: 1.8 mm².
 - Max AWG: 14.
- Narrow knives.
- Cutting depth adjusted by end stop.
- Length: 130 mm.
- Thickness: 4 mm.
- Finish: burnished, PVC grip.



Icon	L [mm]	ΔΔ [g]
194.12	130	70

Wire strippers

- For single or multiple strand wires 0.5 to 6 mm².
- Adjustment screw with lock nut.
- Metal return screw.
- Forged pliers.
- Automatic handle opening for speed and ease of use.

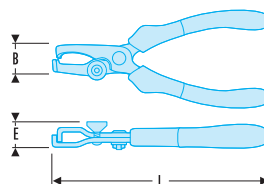

Icon	B [mm]	E [mm]	L [mm]	ΔΔ [g]
194A.17CPE	17	8,5	170	185

Coated wire strippers

- Treated steel blades.
- Plastic stops avoiding hand fatigue.
- Finish: burnished blades.



Icon	l [mm]	L [mm]	ΔΔ [g]
173A	10	135	40



PRE-INSULATED TERMINAL CRIMPING PLIERS

PRE-INSULATED TERMINAL CRIMPING PLIERS

The 3-in-1 pliers to cut, strip and crimp

New multi-function pliers: one tool to cut, strip and crimp wire ends, insulated terminals as well as open core terminals.



Mobile crimping pliers



- For constant and accurate crimping of mechanical, electrical and electronic connectors.
- Perfectly positions the wire in the terminal. The position of the crimping dies provides excellent visibility when inserting the connector and wire.
- Die release system for easy die changing without special tooling.
- One crimper for all dies.
- Ideal for all installers or maintenance technicians who wish to lighten their toolbox and save time during intervention.
- 821461 die: 0.25-0.75 mm², 1-1.5 mm², 2.5 mm², 4 mm², 6 mm², 10 mm².
- 821462 die: 0.5-1.5 mm², 1.5-2.5 mm², AWG 22-16, 16-14.
- 821463 die: Red and blue insulated terminals 0.25-1.5 mm² and 1.5-2.5 mm².
- 821469 die: 0.5-2.5 mm², 4-6 mm² AWG 22-14, 12-10.
- 821464 die: 0.5mm Open barrel.
- 821465 die: Solar connector size 4.
- 821466 die: 0-4mm Power turned pins.
- 821467 die: Insulated heat shrink butt.



	$\Delta\Delta$ [g]
821416	500

Industrial Mobile Crimping Pliers Set with 4 Interchangeable Dies



- For constant and accurate crimping of mechanical, electrical and electronic connectors.
- Perfectly positions the wire in the terminal. The position of the crimping dies provides excellent visibility when inserting the connector and wire.
- Die release system for easy die changing without special tooling.
- One crimper for all dies.
- Ideal for all installers or maintenance technicians who wish to lighten their toolbox and save time during intervention.
- 821461 die: 0.25-0.75 mm², 1-1.5 mm², 2.5 mm², 4 mm², 6 mm², 10 mm².
- 821462 die: 0.5-1.5 mm², 1.5-2.5 mm², AWG 22-16, 16-14.
- 821466 die: 0.14-1 mm², 1.5 mm², 2.5 mm², 4 mm², AWG 16, 14, 26-18, 12.
- 821469 die: 0.5-2.5 mm², 4-6 mm² AWG 22-14, 12-10.



	$\Delta\Delta$ [g]
819832	850

▪ **Electrician's mobile crimping pliers set**

- For constant and accurate crimping of mechanical, electrical and electronic connectors.
- Perfectly positions the wire in the terminal. The position of the crimping dies provides excellent visibility when inserting the connector and wire.
- Die release system for easy die changing without special tooling.
- One crimper for all dies.
- Ideal for all installers or maintenance technicians who wish to lighten their toolbox and save time during intervention.
- Comprising:
 - 1 set of crimping pliers 821416.
 - 4 dies (821461 - 821462 - 821463 - 821469).
 - 1 pair of Swingo® strippers 793936.
 - 1 sheath remover 985956.
 - Plastic case BP.MBOXM.
 - Foam tray PM.819810.



	$\Delta\Delta$ [g]
819810	1617

▪ **All in One electricians / Industrial mobile crimping pliers set**

- Including:
- Multifunction crimping pliers 821416.
 - 2 dies for pre-insulated terminals 0.5 to 6 mm².
 - 2 dies for open core terminals 0.5 to 6 mm².
 - 2 dies for cable terminations from 0.25 to 10 mm².
 - 821464 1 x die for open-barrel connectors.
 - 821460 1 x die for ferrules.
 - 821463 1 x die for pre-insulated connectors green-yellow.
 - Selection of 20 models of pre-insulated terminals and accessories:
 - Eyelets.
 - Fork terminals.
 - Sleeves.
 - Male and female terminals.
 - Plastic tray PL.721.



	$\Delta\Delta$ [g]
855367	1.950

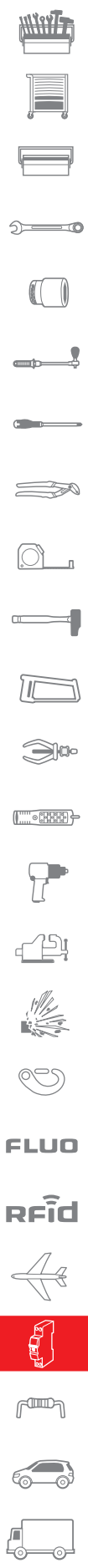

CRIMPING PLIER INSPECTION SERVICE



ISO 9000 quality assurance systems require crimping equipment to be periodically checked for compliance with the standards and recommendations. That is why Facom's laboratory offers this service.

Pliers covered by the inspection service

Pliers for insulated terminals to CEI 760- 985753, 985894, 673838.
Pliers for cable terminals to NFC 20130- 985754, 985755, 985756,- 985896, 985897, 985895.



673838 CRIMPING PLIERS FOR INSULATED TERMINALS WITH LOCATOR



A third hand!

Complies with NFC 63-023

- Automatically positions the terminal to guarantee a secure attachment.
- Stainless steel dies ensuring good wear resistance.
- Reverse crimping for precision and visibility.
- Left/right-hand operation.
- Soft comfortable grips.



Holds the terminal on the pliers.

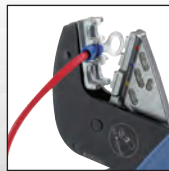

Perfectly positions the wire in the terminal.



Holds the terminal and the wire after crimping.



■ **SERKAN® ratchet crimping pliers for insulated terminals with locator**

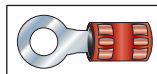

NFC 63-023

- Lower fixed jaw: easy terminal fitting.
- Double crimping with die marking on the insulator.
- Stainless steel die with 3 cavities:
 - Red cavity: 0.5 to 1.5 mm².
 - Blue cavity: 1.5 to 2.5 mm².
 - Yellow cavity: 4 to 6 mm².
- Right/left handed pliers.



673838

ΔΔ [g]
490

■ Maintenance crimping pliers for pre-insulated terminals

CEI60352-2

- Double crimping for pre-insulated terminals in compliance with the standard, with holding on the conductor core and the insulator.
- Unlocking accessible at all times.
- Reversed crimping: terminal positioned on the fixed part for more effectiveness and precision.
- Stainless steel die with 3 cavities:
 - Red cavity: 0.5 --> 1.5 mm².
 - Blue cavity: 1.5 --> 2.5 mm².
 - Yellow cavity: 4 --> 6 mm².
- Shape allowing hand setting.
- Soft touch.

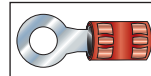

Icon	L [mm]	ΔΔ [g]
985894	230	490

■ Production crimping pliers for insulated terminals

CEI60352-2

- Extended handle for 2-hand grip.
- Disengaging possible during crimping.
- Double crimping of the terminal.
- 3 cavity die:
 - Red cavity: 0.5 to 1 mm².
 - Blue cavity: 1.5 to 2.5 mm².
 - Yellow cavity: 4 to 6 mm².
- Comfort grip.



Icon	L [mm]	ΔΔ [g]
985753	255	540

■ Standard crimping pliers for insulated terminals

- Crimping pre-insulated terminals: 1.5-2.5-6 mm².
- Crimping bare terminals: 1.5-2.5-6 mm².
- Stripping: 0.75 to 6 mm².
- Built-in wire cutting function.

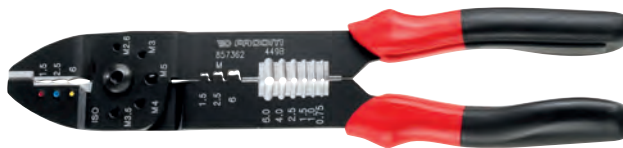

Icon	H [mm]	L [mm]	ΔΔ [g]
449B	55	240	260

TUBULAR TERMINAL AND SLEEVE CRIMPING PLIERS

■ Crimping pliers for tubular terminals

NFC 20-130

- Ratchet pliers with possibility of unlocking in case of mishandling.
- Extended handle for 2-hand grip.
- Capacity 4 to 10 mm².
- Comfort grip.



Icon	L [mm]	ΔΔ [g]
985966	255	500

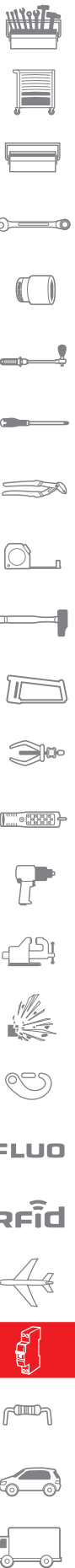

FLUO

RFid

■ Crimping pliers for tubular terminals with rotating dies



NFC 20-130

- Rotating dies indexable in 6 positions:
6 - 10 - 16 - 25 - 35 - 50 mm².
- The pliers can be disengaged during crimping.
- Capacity 6 to 50 mm².



986095	L [mm]	ΔΔ [kg]
	390	1.185

■ Hydraulic trigger crimping pliers for tubular terminals and sleeves



NFC 20-130

- 35 kN.
- Travel adjustable from 5 to 8 mm by rotation of the notched bush reducing the number of pump strokes for smaller sections.
- Rotating head 360°.
- Automatic trigger with audible "click" upon crimping.
- Piston return by discharge lever.
- Supplied in box.



985913	ΔΔ [kg]
	2.130

CRIMPING DIES

■ Hexagonal crimping dies

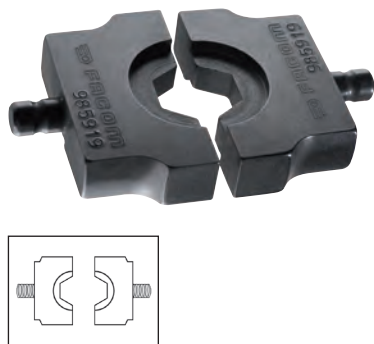

NFC 20-130

- For crimping pliers 985913.
- For tubular terminals and sleeves.



985914	Section [mm ²]	ΔΔ [g]
	6	64
	10	88
	16	91
	25	89
	35	85
	50	79
	70	78
	95	76
	120	61
	150	66

OPEN CORE CONNECTOR CRIMPING PLIERS

Open core connector crimping pliers

DIN 46249

- Die with 3 cavities for open core terminals with 1.5; 2.5 and 6 mm² section.
- Capacity 1.5 to 6 mm².



Model	L [mm]	ΔΔ [g]
985757	195	250

WIRE END CRIMPING PLIERS

Wire end crimping pliers

NFC 63-023

- Stainless steel 5-cavity dies:
 - 0.5 to 0.75 mm².
 - 1 to 1.5 mm².
 - 2.5 mm².
 - 4 mm².
 - 6 mm².
- Unlocking accessible at all times.
- Reversed crimping: terminal positioned on the fixed part for more effectiveness and precision.
- Capacity 0.5 to 6 mm².
- Shape allowing hand setting.
- Soft touch.



Model	L [mm]	ΔΔ [g]
985895	230	490



Serkan 360 All in one Crimper

- Ultimate crimping solution – one gun and no extra dies
- Can be used for most jobs from panel board and cable assembly and connection
- 0.14-10mm square connector – to fit all end sleeves with insulated or insulated profiles
- Tested to 50k cycles – for long life
- Crimp conforms to IEC 60999-1.
- Optimized usage for high volumes.
- Comfortable also for left handed workers.
- Maximum force 10,000 N.m.
- Low hand force needed for operation.
- Light weight ideal for heavy duty use.
- Small handle opening – ideal for smaller hands.



Model	L [mm]	ΔΔ [g]
985905	362	176

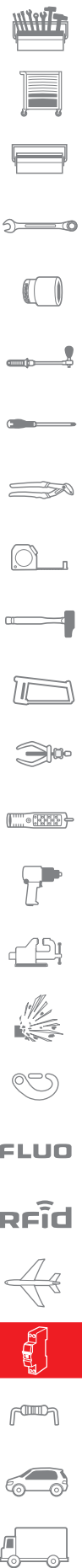

FLUO

RFid

WIRE END CRIMPING PLIERS

Standard wire end crimping pliers



- Capacity: 0.5 to 2.5 mm².
- End nipper.



ED	L [mm]	ΔΔ [g]
985899	140	115

Production wire end crimping pliers



- Easy unlocking in case of mishandling.
- Comfort grip.



ED	L [mm]	Capacity [mm]	Pattern	ΔΔ [g]
985755	195	0,5 -> 6,0 mm ²	5	250
985756	195	4,0 -> 10,0 mm ²	3	500
985896	255	10,0 -> 25,0 mm ²	3	500

TRANSMISSION CONNECTORS CRIMPING PLIERS

Phone connector crimping pliers



- Pliers supplied in a case with the 986022 die for RJ45 connectors.



ED	L [mm]	ΔΔ [g]
985902	205	450

Coax connector crimping pliers

- For BNC connector RG58 - RG59 - RG62.
- Crimping die for coax connectors:
 - 5.36 - 5.46 for RG58.
 - 6.43 - 6.53 for RG59, RG 62.
 - 1.64 - 1.74 for the core.
- Safety rack guaranteeing complete crimping.



🔗	L [mm]	ΔΔ [g]
985758	195	250

Crimping dies for phone connectors

- For crimping pliers 985902.



🔗	d [mm]	ΔΔ [g]
986014	RJ11	50
986022	RJ45	50

TERMINAL SETS

General electricity set

- Including:
- Crimping pliers 449B.
 - Selection of 20 models of pre-insulated terminals and accessories:
 - Eyelets.
 - Fork terminals.
 - Sleeves.
 - Male and female terminals.



🔗	ΔΔ [g]
449.Z3A	1.850



SLEEVING PLIERS

Sleeving pliers

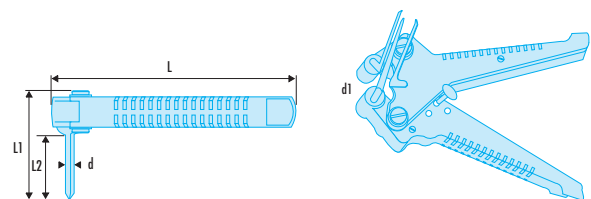

Part No.	d [mm]	d1 [mm]	H [mm]	L [mm]	L1 [mm]	L2 [mm]	Wire Ø [mm]	ΔΔ [g]
985763	3,5	12-16 -24	52	140	52	23	1,25 -> 4,50	165
985764	4,5	13-18 -24	56	140	56	30	1,75 -> 9,00	165
985765	5,0	14-18 -25	66	140	66	40	3 -> 15	165
640171	10,0	19,5 -22,5 - 30,0	82	150	82	56	10 -> 28	149

PLASTIC CABLE-TIE PLIERS

Plastic cable-tie pliers



- For all cable-ties 2.4 to 9 mm wide.
- Sturdy and easy to use, very good demultiplication.
- Long travel for a fast approach.
- Manual cable-tie tail cutting.

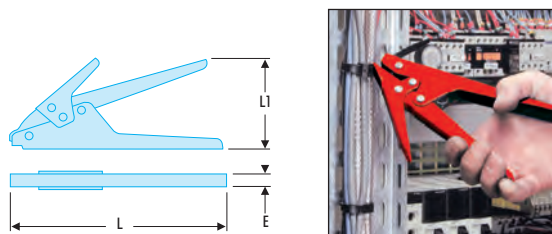

Part No.	E [mm]	L [mm]	L1 [mm]	ΔΔ [g]
455B	17	190	100	310

Automatic plastic cable-tie pliers



- For cable-ties 2.2 to 4.8 mm wide and 1.6 mm thick.
- Adjustable tightening strength.
- Automatic cable-tie tail cutting.

Part No.	ΔΔ [g]
986075	290

NYLON RODS

FISH TAPES

3 types of wire puller!



- Nylon**
- Relatively uncongested cable ducts with average bends, Distance < 20 m.
 - Very high tensile strength.



- Glass fibre**
- Congested cable ducts with multiple bends, 20 m < distance < 40 m.
 - Material has excellent dynamic.
 - Maintains its efficiency after passing an obstacle.

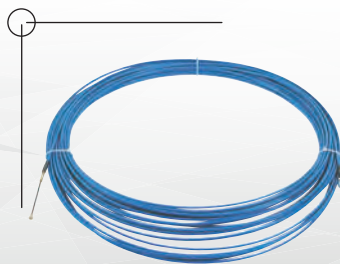

- Nylon-coated steel**
- Long runs in highways 30 m < distance < 50 m.
 - Excellent dynamic properties.
 - Pushing force for tubes Ø 24 mm and over.

■ Nylon rods



- Supplied with:
 - 1 flexible guiding head.
 - 1 pulling eye.
- Breakage load: 120 kN.
- Diameter: 4 mm.

ED	d [mm]	L [m]	ΔΔ [g]
629731	4	10	168
629757	4	20	313

■ Nylon rod 20 m + needle holder casing



- Supplied with:
 - 1 flexible guiding head.
 - 1 pulling eye.
- Breakage load: 120 kN.
- For poorly clogged and medium curved ducts.
- For distance below 20 m.

ED	d [mm]	L [m]	ΔΔ [g]
669273	4	20	554

GLASS FIBRE RODS

■ Glass fibre rods

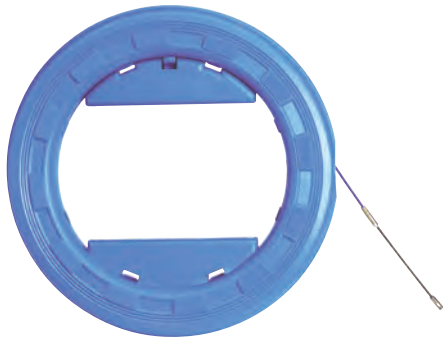

- Supplied in a needle holder casing with:
 - 1 flexible guiding head.
 - 1 pulling eye.
 - 1 repair set.
- Breakage load: 120 kN.

REF	d [mm]	L [m]	ΔΔ [g]
629853	3	30	585
629861	3	40	684

NYLON RODS

■ Needle holder casing



- For a rod 10 to 40 m long.
- Housing for accessories and repair kit.

REF	ΔΔ [g]
629765	267

ACCESSORIES

■ Nylon steel rod

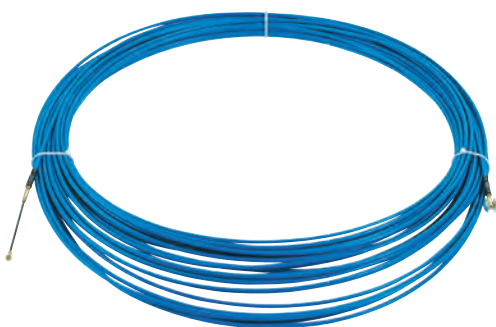

- Ideal for long ducts.
- High traction power.
- Breakage load: 200 kN.
- Rod length: 50 m.
- Diameter 6 mm.
- Supplied with:
 - 1 flexible guiding head.
 - 1 slide wheel with swage.
 - 1 snap hook.

REF	ΔΔ [g]
629896	200

■ Fish tape pulling pliers

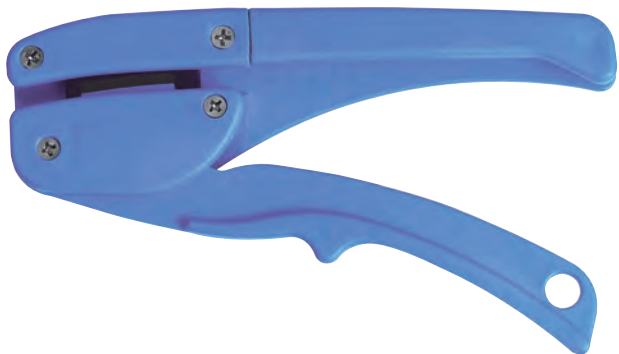

- Easy handling of rods without damaging them and avoiding hand injuries.
- Shock-proof material.

REF	ΔΔ [g]
629773	95

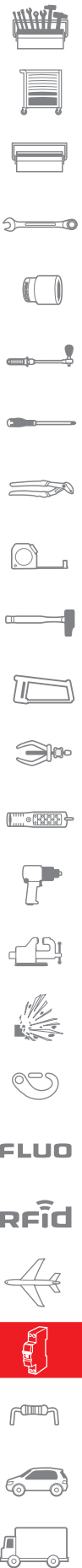

ACCESSORIES

■ Glass fibre rod repair kit



Including:

- 2 bits.
- 1 seal.
- 1 specific glue.

	$\Delta\Delta$ [g]
629888	12

■ Lubricant



- To be sprayed on the cable before pulling it.
- Facilitates pulling.
- Supplied in 1-litre bottle.

	$\Delta\Delta$ [kg]
629984	1.1

CONSUMABLES FOR NYLON AND GLASS FIBRE RODS

■ Flexible guiding head for nylon and glass fiber rods

- Female part: M4 threading.



	$\Delta\Delta$ [g]
629781	9



ACCESSORIES FOR NYLON STEEL RODS

■ Tropic-proof steel reel

- Fast guiding and winding of the the rod.
- Ideal for long rods.
- Storage of nylon steel rods up to 150 m.
- Axis on ball bearing.
- Withstands heat and humidity.

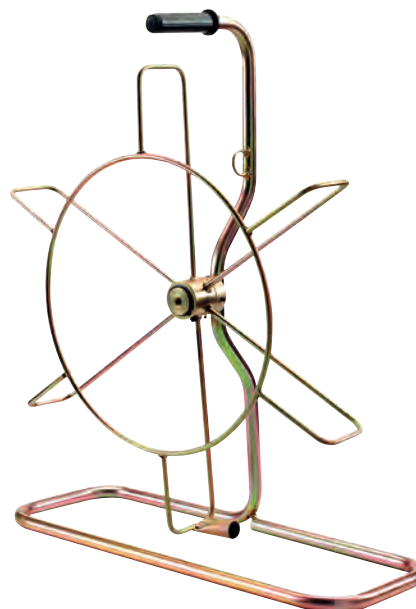

	$\Delta\Delta$ [g]
629909	5900

HOLE PUNCHES FOR ISO HOLE SIZES

HOLE PUNCH FOR ISO HOLE SIZES

- 3 section ISO splitting punch.
- Spread: ISO 12 to ISO 63.
- Blanks split into three, thus preventing the actuating screw from jamming.
- Cutting-point geometry ensures longer life.
- Available with or without a thrust-bearing screw.

1 - For ordinary steel ST37

- Max. sheet thickness: 2 mm.
- Pilot hole: - Screw \varnothing + min 0.2 mm.



HOLE PUNCH FOR PG HOLE SIZES

- Spread: PG7 to PG48.

2 - For ordinary steel ST37

- 3-point punch.
- Circular blank automatically drops out after punching with a couple more turns of the wrench.
- Max. thickness:
 - 2 mm with screw \varnothing 9.5 mm.
 - 3 mm with screw \varnothing 19 mm.
- Pilot hole:
 - Screw \varnothing + min 0.2 mm.



FACOM HOLE PUNCHES CAN BE OPERATED IN THE FOLLOWING WAY:



With a wrench
For hole punches fitted
with a thrust-bearing screw.

DIMENSIONS (mm):

ISO12	ISO16	ISO20	ISO25	ISO32	ISO40	ISO50	ISO63		
12.5	16.5	20.5	25.5	32.5	40.5	50.5	63.5		
PG7	PG9	PG11	PG13	PG16	PG21	PG29	PG36	PG42	PG78
12.7	15.2	18.6	20.4	22.5	28.3	37	47	54	60

ISO EN 50262 REQUIREMENTS

- This international standard specifies the electrical functions and performance of cable entries.
- It stipulates that only ISO metric threads are to be used for cable glands since September '99.
- The use of PG threads will still be allowed for the maintenance of existing equipment despite no longer being covered by any national or international standard.

Remember to apply lubricant to the screw/pin for optimum operation of the punch.

CUSTOM SIZE KNOCKOUT PUNCH

Please consult us for your specific punch size or shape requirements.



FLUO

RFid



HOLE PUNCHES FOR ISO SIZES

■ Punches for PG size holes with actuating screw



- For circular cut out in metal sheet and plastic.
- Operated with a wrench or ratchet/socket set.
- Fast, clean and burr-free cut out.
- For all diameters PG 7 to PG 48.
- Parts greased for better use.
- TIP: the round cut falls much easier when applying 2 or 3 additional turns with the tightening wrench after cutting out.
- Supplied with punc, die, and ball stop screw.

Table caption:

- d = PG diameter/mm.
- d1 = drilling diameter/mm.
- Screw = dimension on flat (mm)/ operating screw.
- E = max/thickness steel/soft.

➤	d [mm]	d1 [mm]	E [mm]	PG	PG	Screw Size [mm]	ΔΔ [g]
985968	12,7	11	2	7	7	17	108
985969	15,2	11	2	9	9	17	114
985972	18,6	11	2	11	11	17	120
985974	20,4	11	2	13	13	17	120
985978	22,5	11	2	16	16	17	128
985984	28,3	11	3	21	21	17	130
985995	37,0	11	3	29	29	27	140

■ Punches for ISO size holes with actuating screw



- For circular cut out in metal sheet and plastic.
- Operated with a wrench or ratchet/socket set.
- Fast, clean and burr-free cut out.
- For all ISO diameters from M12 to M63.
- Parts greased for better use.
- PRODUCT PLUS: the round is slit into three parts and falls automatically at the end of the cutting operation.
- Supplied with punch, die, and ball stop screw.

Table caption:

- d = ISO diameter/mm.
- d1 = drilling diameter/mm.
- Screw = dimension on flat (mm)/ operating screw.
- E = max/thickness steel/soft.

➤	d [mm]	d1 [mm]	E [mm]	ISO	Screw Size [mm]	ΔΔ [g]
693716	12,5	11	2	M12	17	55
697590	16,2	11	2	M16	17	122
693695	20,4	11	2	M20	17	148
697602	25,4	11	2	M25	17	183
697611	32,5	22	2	M32	27	436
697645	40,5	22	2	M40	27	576
697637	50,5	22	2	M50	27	816
697653	63,5	22	2	M63	27	754

ACCESSORIES

ISO staged drill bit

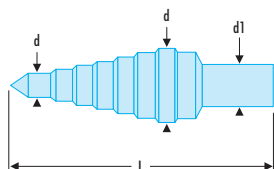

- For cylindrical high accuracy drilling in all diameters.
- Does not require a tapping hole.
- Cylindrical shank with 3 flats for proper drive, avoiding micro locking.
- Marking of different diameters.
- 678014: Special PG cable gland.
- Panel drilling capacity up to 4 mm thickness.
- Shank diameter 10 mm.

678006	d mini - maxi [mm]	d1 [mm]	L [mm]	ΔΔ [g]
	6,5 - 8,5 - 10,5 - 12,5 - 16,5 - 20,5 - 25,5 - 29,0 - 32,5 - 36,5 - 40,5	10	96	310

PG staged drill bit

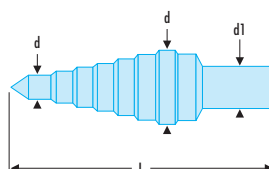

- For cylindrical high accuracy drilling in all diameters.
- Does not require a tapping hole.
- Cylindrical shank with 3 flats for proper drive, avoiding micro locking.
- Marking of different diameters.
- 678014: Special PG cable gland.
- Panel drilling capacity up to 4 mm thickness.
- Shank diameter 10 mm.

678014	d mini - maxi [mm]	d1 [mm]	L [mm]	ΔΔ [g]
	6,0 - 9,0 - 12,5 - 15,2 - 18,6 - 20,4 - 22,5 - 26,0 - 28,3 - 30,5 - 34,0 - 37,0	10	100	300

Drill bit diameter 11 mm



- Drill bit diameter 11 mm for tapping hole.

986051	ΔΔ [g]
	310

Lubricating paste



- To lubricate the screws and drive axes.

986107	ΔΔ [g]
	150



TESTERS

Clip-on ammeter



- Allows current measurements without contact.
- Compatible with most multimeters.
- Automatic zero point adjustment, perfectly suited to FACOM multimeters 711, 711A, 714 and 714A.
- AC / DC measurement: 0 to 600 A.
- Frequency response: 50 Hz - 60 Hz.
- 600 V CAT III.

720.P1500 $\Delta\Delta$ [g] 450

Clip-on multimeter



- Multimeter for mobile maintenance.
- Current measurement without contact, withstands difficult environments.
- DC / AC voltmeter: 0 to 600 V. • DC / AC ammeter: 0 to 400 A.
- Ohmmeter: 0 to 40 MO.
- Continuity test with buzzer.
- Diode test.
- Temperature measurement with K thermocouple.
- 600 V CAT III.

712A $\Delta\Delta$ [g] 510

THE RIGHT TESTER FOR YOUR NEEDS

Simple

- Automatic calibration: easy to use, no risk of error.
- Wide screen providing clear, detailed readings.

Safe

- Meets safety standard requirements.
- Contact-free measurement with the testing tips.

Operational

- Shock-proof coating: resistant to industrial environments.
- Cable storage: saves time.



Multimeter



- Maintenance multimeter.
- Ideal for repairing electronic or electromechanical assemblies and for teaching.
- DC / AC voltmeter: 0 to 600 V.
- DC / AC ammeter: 0 to 10 A.
- Ohmmeter: 0 to 40 MO.
- Capacimeter: 0 to 100 μ F.
- Frequency meter: 0 to 100 KHZ.
- Cyclic ratio: 5% to 99 %.
- Diode test.
- Continuity test with buzzer.
- 600 V CAT III.

711A $\Delta\Delta$ [g] 803

TESTERS

VAT DETECTOR: WORK SAFELY

- Check the absence of voltage before starting work around or on a component likely to be live.
- Directive C18-510 imposes the use of a VAT tester, such as the FACOM 701B VAT.
- The FACOM 701B is a must for professionals in construction, industrial maintenance and electricians, ensuring safe and fast work.



■ DAT VAT safety tester

NF EN 601010 - 600 V, IEC 612 43 - 3

- Indispensable for construction and repairing in industrial environments.
- The VAT test allows to check the lack of voltage on a circuit before starting the work.
- Auto test.
- Hazardous voltage detection.
- Phase detector.
- Continuity test with buzzer.
- Differential circuit breaker test: 30 mA.
- Phase rotation indicator.
- 600 V CAT III.



Model	Weight $\Delta\Delta$ [g]
701B	380

THERMOMETER

■ Combination electronic thermometer



- Infrared thermometer with laser aiming.
- Connector for measuring with "K" thermocouples.
- Adjustable emissivity.
- Infrared measurement range: -60°C to +600°C.
- D/S ratio: 11/1.
- Mode: differential, minimum, maximum, average, alarm.

Model	Weight $\Delta\Delta$ [g]
DX.T100	328



■ DX.12 Temperature probes



Model	For	Weight $\Delta\Delta$ [g]
DX.12-08	Bracket probe	20
DX.12-11	Standard needle probe	95
DX.12-15	Extension	117
DX.12-17	Surface contact probe	105
DX.12R	Air probe	45



PLIERS

NEW 1,000 VOLTS INSULATED PLIERS

Increased durability:
longer life performance**Less effort**

- Cutting requires less force, return spring reduces total user effort and strain.

**Insulation tests**

- Tools to EN 60900 specifications
- 1-Immersion test
 - 2-Penetration test
 - 3-Insulation adhesion test
 - 4-Impact test
 - 5-Non-flammability test

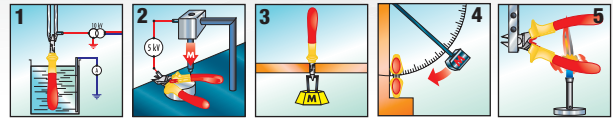

- Sculptured upper section with finger-guard provides a natural fit to aid grip.

- Wide lower section to increase contact with the plier aiding both grip and comfort.

**Soft grip**

- For improved comfort.

Information

- Compliance with European standard EN 60900.
- For working on live components up to 1,000 volt AC.
- Each and every tool is tested to 10,000 volts for 10 seconds at the end of the manufacturing cycle.
- Our production site is accredited and certified to produce insulated tools.

Safety

- Prevent damage to insulation from:
 - Heat (-20 to +70°C working temperature)
 - Chemicals
 - Cuts or perforations.
- Check insulation is sound before using a tool.
- Wear insulating gloves and eye protection.



■ **192A.VE - 1,000 Volt insulated high-performance diagonal cutters**

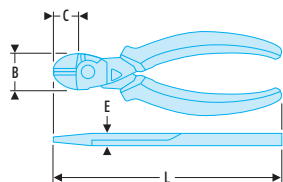

NF ISO 5749, ISO 5749, DIN ISO 5749, ASME B107.500,
NF EN 60900, EN 60900, DIN EN 60900

- For your safety, all pliers are tested individually at 10,000 volts for 10 seconds, at the end of the manufacturing cycle.
- New head design to increase durability and cutting capacity
- Cutting edges designed to cleanly cut all types of wire: soft wires and modern materials to a maximum piano wire specification of:
 - 192A.16VE : 2.0mm 210 kg/mm²
 - 192A.18VE : 2.2mm 205 kg/mm²
- High mechanical advantage due to off-set rivet and cutting edge geometry reducing effort.
- High durability Carbon alloy steel, with induction hardened cutting edges.
- Bi-Material ergonomic grips resistant to chemical agents.
 - Positive return spring
 - Tether ready
 (Tether point adds 10mm to nominal length)
- Varnish finish to help prevent rusting.



	B [mm]	C [mm]	E [mm]	L [mm]	ΔΔ [g]
192A.16VE	24,0	18,0	10,0	160	200
192A.18VE	26,0	20,0	11,0	180	260

■ **391A.VE - 1,000 volt insulated electricians diagonal cutters**

NF ISO 5749, ISO 5749, DIN ISO 5749, ASME B107.500

- Snipe nose for confined space (electrical cabinets, wiring).
- Cutting edges designed to cleanly cut all types of wire: soft wires and modern materials to a maximum piano wire specification of:
 - 391A.14VE: 1.4mm 225 kg/mm²
 - 391A.16VE: 1.6mm 220 kg/mm²
- High mechanical advantage due to off-set rivet and cutting edge geometry reducing effort.
- High durability chrome-molybdenum-vanadium steel, with induction hardened cutting edges.
- Bi-Material ergonomic grips resistant to chemical agents.
 - Positive return spring
 - Tether ready

(Tether point adds 10mm to nominal length)

- Chrome finish for corrosion resistance.

	B [mm]	B1 [mm]	C [mm]	E [mm]	L [mm]	L1 [mm]	ΔΔ [g]
391A.14VE	21,5	14	15,5	9,5	145	9	160
391A.16VE	19	15	21	10	165	9	190

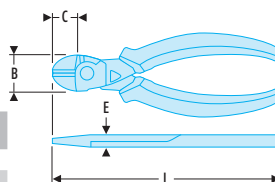

■ **1,000 Volt insulated high-performance end cutters**

NF ISO 5748, ISO 5748, DIN ISO 5748, ASME B107.500

- Cutting edges designed to cleanly cut all types of wire: soft wires and modern materials to a maximum piano wire specification of:
 - 190A.16VE: 2.0mm 210 kg/mm²
 - 190A.20VE: 2.5mm 200 kg/mm²
- High mechanical advantage due to off-set rivet and cutting edge geometry reducing effort.
- High durability Carbon alloy steel, with induction hardened cutting edges.
- Bi-Material ergonomic grips resistant to chemical agents.
 - Positive return spring
 - Tether ready tether point

(Tether point adds 10mm to nominal length)

- Chrome finish for corrosion resistance.

	A [mm]	B [mm]	C [mm]	E [mm]	L [mm]	ΔΔ [g]
190A.16VE	6,5	28	6,5	11,5	160	200

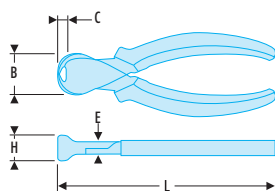

■ **185-195.VE - 1,000 Volt insulated long half-round nose pliers**

NF ISO 5745, ISO 5745, DIN ISO 5745, ASME B107.500, NF EN 60900, EN 60900, DIN EN 60900

- For your safety, all pliers are tested individually at 10,000 volts for 10 seconds, at the end of the manufacturing cycle.
- Slim, fine serrated noses.
- Lateral wire cutter for copper and hard steel wire.
- 185A.20VE: straight nose. Approved by VDE.
- 195A.20VE: 40° angled nose.
- Removable return spring.
- Ergonomic anti-slip grips.
- Finish: polished, varnished.

	B [mm]	C [mm]	d [mm]	E [mm]	L [mm]	ΔΔ [g]
185A.20VE	18	75	2,9	3,6	200	192
195A.20VE	18	69	2,9	3,6	200	192

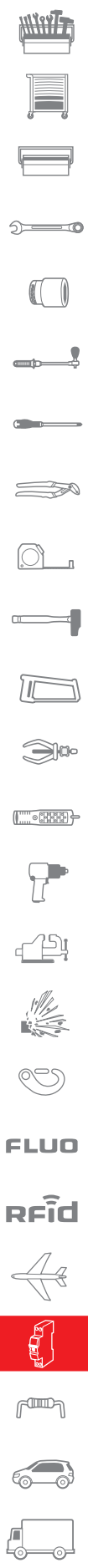
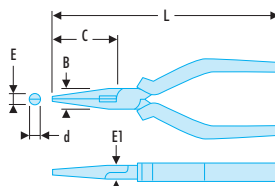

PLIERS

■ 193A-195A.VE - 1,000 Volt insulated short half-round nose pliers



195A.16VE

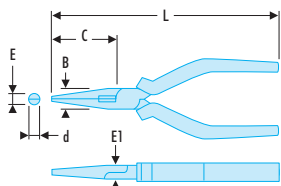

NF ISO 5745, ISO 5745, DIN ISO 5745, ASME B107.500,
NF EN 60900, EN 60900, DIN EN 60900

- For your safety, all pliers are tested individually at 10,000 volts for 10 seconds, at the end of the manufacturing cycle.
- Narrow, finely serrated tips with side cutting edges.
 - 193A.VE: straight nose.
 - 195A.VE: 40° angled nose.
- Cutting edges for copper and hard steel wire to a maximum specification of 1.6mm 160 kg/mm².
- High durability Carbon alloy steel, with induction hardened cutting edges.
- Bi-Material ergonomic grips resistant to chemical agents featuring:
 - Positive return spring
 - Tether ready (Tether point adds 10mm to nominal length)
- Varnish finish to help prevent rusting.



🔧	B [mm]	C [mm]	d [mm]	E [mm]	L [mm]	ΔΔ [g]
193A.16VE	17	50	2,5	3	160	177
195A.16VE	17	50	2,5	3	160	177

■ High-capacity 1,000 Volt insulated multigrip pliers

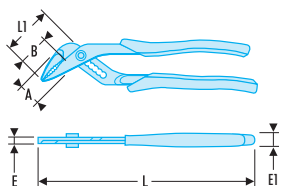

NF ISO 8976, NF EN 60900, ISO 8976, EN 60900,
DIN ISO 8976, DIN EN 60900, ASME B107.500

- Capacity: 44 mm.
- Ideal for confined spaces: long reach thin noses.
- Double heat-treated tips: high wear resistance, hardness 60/62 HRC.
 - 180.VE: varnish finish, 1,000 V insulated grips designed for electrical safety to EN 60900 and VDE certified for working on or near live components.



🔧	A [mm]	B [mm]	C [mm]	E [mm]	E1 [mm]	L [mm]	L1 [mm]	ΔΔ [g]
180.VE	30	30	35	8	22	250	58	360

■ 187A.VE - 1,000 Volt insulated combination pliers



187A.16VE

187A.18VE

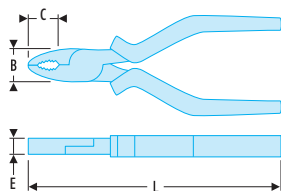

NF ISO 5746, ISO 5746, DIN ISO 5746, ASME B107.500,
NF EN 60900, EN 60900, DIN EN 60900

- For your safety, all pliers are tested individually at 10,000 volts for 10 seconds, at the end of the manufacturing cycle.
- Serrated flat and oval pipe/cable gripping surfaces combined with a high performance cutting edges.
- Cutting edges designed to cleanly cut all types of wire: soft wires and modern materials to a maximum piano wire specification of:
 - 187A.16VE : 1.8mm 215 kg/mm²
 - 187A.18VE : 2.0mm 210 kg/mm²
- High mechanical advantage due to off-set rivet and cutting edge geometry reducing effort.
- High durability Carbon alloy steel, with induction hardened cutting edges.
- Mono-Material ergonomic grips maintaining accessibility benefits of classic dip grips, resistant to workshop chemical agents
- Varnish finish to help prevent rusting.



🔧	B [mm]	C [mm]	E [mm]	L [mm]	ΔΔ [g]
187A.16VE	21	34	9,5	165	195
187A.18VE	23	36	10,0	185	225

188A.VE - 1,000 Volt insulated flat nose pliers

NF ISO 5745, ISO 5745, DIN ISO 5745, ASME B107.500, NF EN 60900, EN 60900, DIN EN 60900

- For your safety, all pliers are tested individually at 10,000 volts for 10 seconds, at the end of the manufacturing cycle.
- Narrow flat shaped and finely serrated nose for a firm grip and accessibility
- High durability Carbon alloy steel.
- Bi-Material ergonomic grips resistant to chemical agents featuring:
 - Positive return spring
 - Tether ready
(Tether point adds 10mm to nominal length)
- Varnish finish to help prevent rusting.

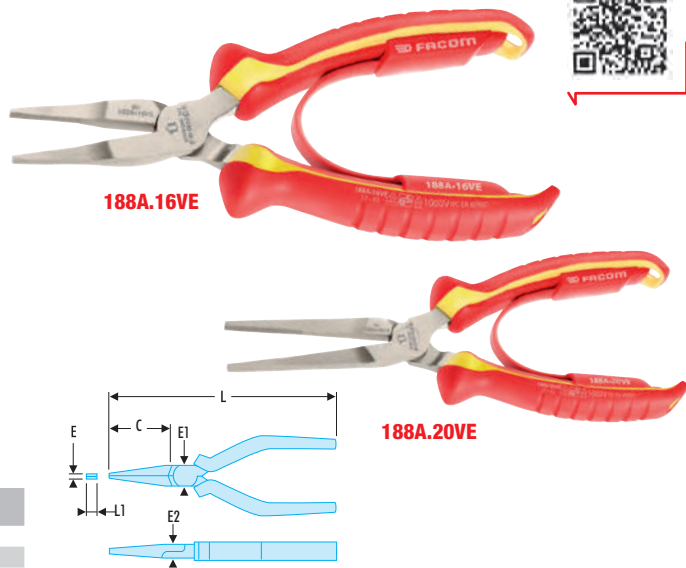

	B [mm]	E [mm]	L [mm]	L1 [mm]	ΔΔ [g]
188A.16VE	46	4	168	6,5	140
188A.20VE	75	4	200	6,5	200

1,000 Volt insulated round nose pliers

NF ISO 5745, ISO 5745, DIN ISO 5745, ASME B107.500, NF EN 60900, EN 60900, DIN EN 60900

- For your safety, all pliers are tested individually at 10,000 volts for 10 seconds, at the end of the manufacturing cycle.
- For shaping loops, bends or rings.
- Finely serrated jaws for a positive grip.
- Diameter of each nose at the end: 2 mm.
- High durability Carbon alloy steel.
- Bi-Material ergonomic grips resistant to chemical agents featuring:
 - Positive return spring
 - Tether ready tether point
(Tether point adds 10mm to nominal length)
- Varnish finish to help prevent rusting.

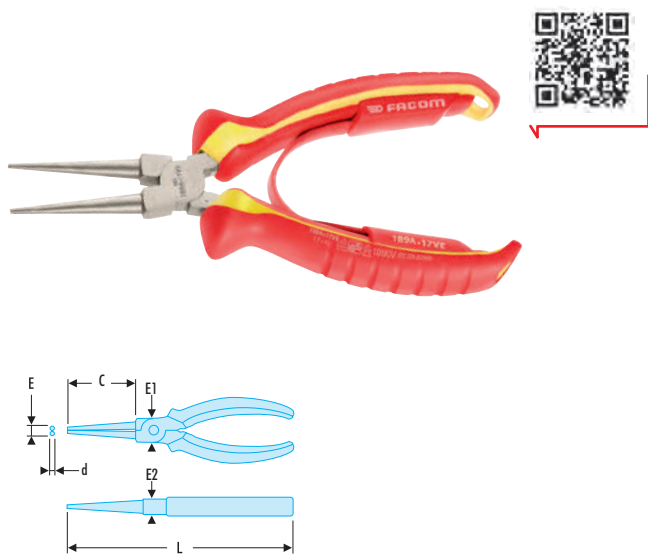

	C [mm]	d [mm]	E [mm]	L [mm]	ΔΔ [g]
189A.17VE	41	2	4	170	135

1,000 Volt insulated strippers

NF EN 60900, EN 60900, DIN EN 60900

- For your safety, all pliers are tested individually at 10,000 volts for 10 seconds, at the end of the manufacturing cycle.
- For multiple or single strand wires 0.5 --> 6 mm².
- Adjustment screw with lock nut.
- Metal return screw.
- Ergonomic anti-slip grips.
- Finish: polished, varnished.



	B [mm]	E [mm]	L [mm]	ΔΔ [g]
194A.17VE	17	8,5	170	185

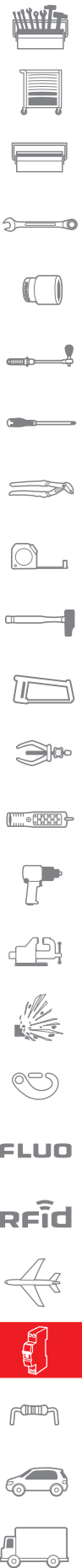

FLUO

RFid



SCREWDRIVERS

■ **AT.VE - PROTWIST® 1,000 Volt insulated screwdrivers for slotted-head screws**

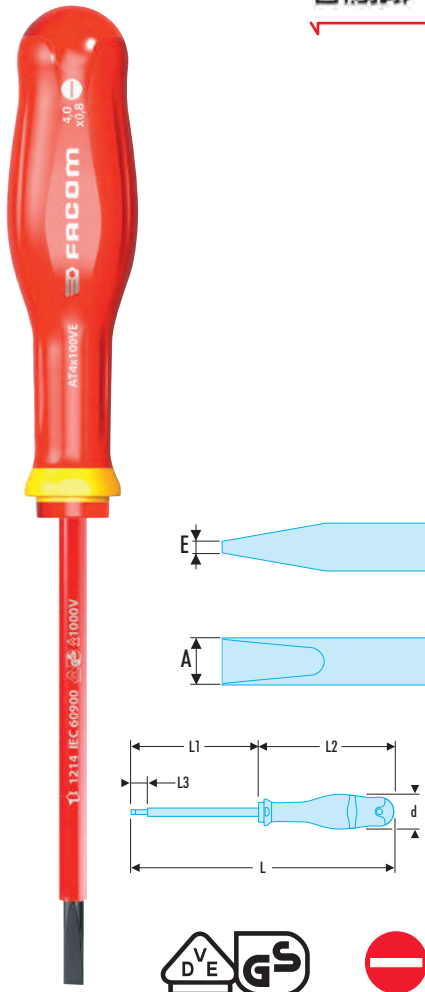

NF ISO 2380-1, NF ISO 2380-2, NF EN 60900, ISO 2380-1, ISO 2380-2, EN 60900, DIN ISO 2380-1, DIN ISO 2380-2, DIN EN 60900, ASME B107.600

- For your safety, each screwdriver is tested individually at 10,000 volts for 10 seconds, at the end of the manufacturing cycle.
- 1,000 Volt sheathed round blade.
- Milled blade: --> 5.5 mm included.
- Fillet blade: 6.5 --> 12 mm.
- Bi-material grip resists to impacts, abrasion, and chemicals.
- New chemical resistant handle with "power" channel for higher torque transfer.
- New softer handle material for improved comfort.

ED	A [mm]	d [mm]	E [mm]	L [mm]	L1 [mm]	L2 [mm]	L3 [mm]	ΔΔ [g]
AT2X75VE	2,0	19	0,4	170	40	95	18	23
AT2.5X50VE	2,5	25	0,4	153	50	103	18	30
AT2.5x75VE	2,5	25	0,4	178	75	103	18	32
AT3X75VE	3,0	25	0,5	178	75	103	18	38
AT3X100VE	3,0	25	0,5	202	100	103	18	39
AT3.5x75VE	3,5	25	0,6	179	75	104	18	42
AT3.5x100VE	3,5	25	0,6	204	100	104	18	44
AT4X100VE	4,0	30	0,8	210	100	110	18	48
AT4X150VE	4,0	30	0,8	260	150	110	18	53
AT5.5x125VE	5,5	30	1,0	235	125	110	18	88
AT5.5x150VE	5,5	30	1,0	260	150	110	18	92
AT5.5x200VE	5,5	30	1,0	310	200	110	18	106
AT6.5x150VE	6,5	36	1,2	270	150	120	18	120
AT6.5x200VE	6,5	36	1,2	320	200	120	18	170
AT8X150VE	8,0	40	1,2	275	150	125	18	160
AT8X200VE	8,0	40	1,2	325	200	125	18	180
AT10X200VE	10,0	40	1,6	325	200	125	18	240
AT12X250VE	12,0	40	2,0	375	250	125	18	360

■ **ATP.VE - PROTWIST® 1,000 Volt insulated screwdrivers for Phillips® head screws**



NF ISO 8764-1, NF ISO 8764-2, NF EN 60900, ISO 8764-1, ISO 8764-2, EN 60900, DIN ISO 8764-1, DIN ISO 8764-2, DIN EN 60900, ASME B107.600

- For your safety, each screwdriver is tested individually at 10,000 volts for 10 seconds, at the end of the manufacturing cycle.
- 1,000 Volt sheathed round blade.
- Bi-material grip resists to impacts, abrasion, and chemicals.
- New chemical resistant handle with "power" channel for higher torque transfer.
- New softer handle material for improved comfort.

ED	Phillips [No]	d [mm]	d1 [mm]	L [mm]	L1 [mm]	L2 [mm]	L3 [mm]	ΔΔ [g]
ATPOX75VE	PH0	25	3,0	179	75	104	18	46
ATP1X100VE	PH1	30	4,5	210	100	110	18	77
ATP2X125VE	PH2	36	6,0	215	125	120	18	127
ATP3X150VE	PH3	40	8,0	275	150	125	18	195
ATP4X200VE	PH4	40	10,0	375	200	125	18	278

■ **ATD.VE - PROTWIST® 1,000 Volt insulated screwdrivers for Pozidriv® head screws**

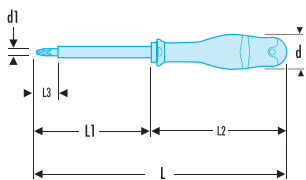

■ **AT.VE - Sets of PROTWIST® 1,000 Volt insulated screwdrivers**



NF ISO 8764-1, NF ISO 8764-2, NF EN 60900, ISO 8764-1, ISO 8764-2, EN 60900, DIN ISO 8764-1, DIN ISO 8764-2, DIN EN 60900, ASME B107.600

- For your safety, each screwdriver is tested individually at 10,000 volts for 10 seconds, at the end of the manufacturing cycle.
- 1,000 Volt sheathed round blade.
- Bi-material grip resists to impacts, abrasion, and chemicals.

- For your safety, each screwdriver is tested individually at 10,000 volts for 10 seconds, at the end of the manufacturing cycle.
- Supplied in a box.

	Pozidriv [No]	d [mm]	d1 [mm]	L [mm]	L1 [mm]	L2 [mm]	L3 [mm]	ΔΔ [g]
ATD0X75VE	PZ0	25	3,0	179	75	104	18	46
ATD1X100VE	PZ1	30	4,5	209	100	109	18	77
ATD2X125VE	PZ2	36	6,0	245	125	120	18	127
ATD3X150VE	PZ3	40	8,0	275	150	125	18	195

	Qty	ΔΔ [g]
ATD.J5VE	3.5mm, 4mm, 5.5mm, PZ1, PZ2	430
ATD.J8VE	2.5mm, 3mm, 3.5mm, 4mm, 5.5mm, 6.5mm, PZ1, PZ2	650
ATP.J5VE	3.5mm, 4mm, 5.5mm, PH1, PH2	430



BORNEO & SLIM SCREWDRIVERS

433

MULTIGRIP PLIERS

FACOM VSE - A COMPREHENSIVE RANGE OF 1,000 VOLT INSULATED TOOLS

For use on live components!

"Safety" colour coding
ORANGE:
1,000 V protection.



YELLOW visible:
STOP
and change tool.



"CERTIFIED" SAFETY
Correct use of insulated tools



ALWAYS wear insulating gloves and eye protection. Check insulation is sound before using a tool.

- Never use a tool with cracked, cut or damaged insulation in any way.
- Discard tools if their insulation looks unsafe.
- Don't alter the insulation.
- Don't let other people use your insulated tools.
- Always use the correct tool.
- Check that the tool bears standard and approval markings.
- Read safety recommendations and keep the instructions. These products come with safety recommendations.
- Beware of electrical hazards.
- Prevent damage to insulation from :
 - Heat (-20 to 70°C working temperature),
 - Cuts or perforations.,
 - Chemicals. Visually check the insulation before use.
- Wear insulating gloves and eye protection.
 - 2-colour insulation :
 - Orange = safe.
 - Yellow = STOP.



- 1 Basic tool:** Facom performance and safety.
- 2 Insulation:** Certified and accredited Facom production site. Tested and approved products.
- 3 2-colour warning insulation:** ORANGE = 1,000 V protection. YELLOW VISIBLE = STOP and change tool.
- 4 Ribbing on flexible insulation:** More secure grip.
- 5 Generously-sized guards:** Hand stays clear of the metal.
- 6 Hot markings:** Permanent safety data. Traceability.

Tools to EN60900 specifications

Individual production test: Each and every tool is tested to 10,000 volts for 10 seconds at the end of the manufacturing cycle.

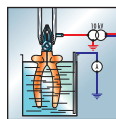

Dielectric test:

After 24 hours immersion, the tool is wiped and tested to 10,000 V for 3 minutes between metal and sheath surface. Leakage current should not exceed specified limits.

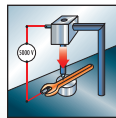

Penetration test: After a penetration test on the most vulnerable part of the tool, followed by heating and cooling, no breakdown or flashover should occur when 5,000 volts is applied for a period of 3 minutes.

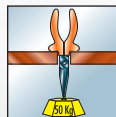

Insulation adhesion test:

A 50 kg tear test is carried out for 3 minutes at ambient temperature on a tool heated to 70°C for 168 hours. Sheath and guard should remain bonded to the metal.

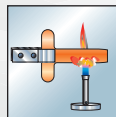

Non-flammability test:

After exposure to a flame for 10 seconds, flame spread over the tool should not exceed 120 mm high within the next 20 seconds.

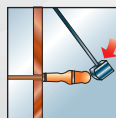

Impact test:

A standard force is repeatedly applied to the handle end of a tool cooled to -25°C for 2 hours. The sheathing should not crack.

VSE series 1,000 Volt insulated multigrip pliers

NF ISO 8976, NF EN 60900, ISO 8976, EN 60900,
DIN ISO 8976, DIN EN 60900
• Insulation with "safety" colour coding.

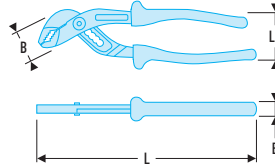

▣	B [mm]	E [mm]	L [mm]	L1 [mm]	Δ [g]
180.VSE	40	35	250	85	360

FACOM VSE 1,000 VOLTS®





**Tools built for electrical safety
to European standard EN 60900.
For working on live components
up to 1,000 Volt AC and 1,500 Volt DC.**

SAFETY COLOUR-CODING	◆ ORANGE:
	1,000 Volt protection.
	◆ YELLOW VISIBLE:
	STOP and change tool.

CUTTING PLIERS

192.AVSE - VSE series 1,000 Volt insulated diagonal cutting pliers for hard wire

NF ISO 5749, NF EN 60900, ISO 5749, EN 60900, DIN ISO 5749,
DIN EN 60900, ASME B107.500

- Tempered cutting edges for hardness above 60 HRC.
- 3 cutting diameters/200 kg/mm²: 1.4 - 1.6 - 1.8 mm.
- Insulation with "safety" colour coding.
- Finish: burnished head.

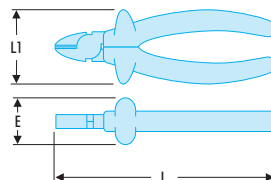

▣	E [mm]	H [mm]	L [mm]	L1 [mm]	200 kg/mm ² (Ø mm)	Δ [g]
192.14AVSE	30	30	145	70	1,4	210
192.16AVSE	35	35	165	75	1,6	270
192.18AVSE	40	40	185	75	1,8	370

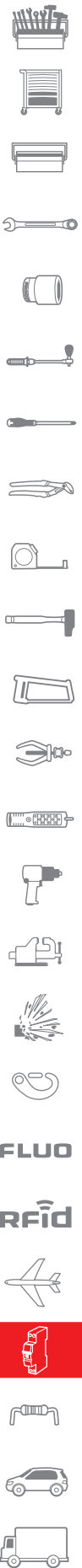

FLUO

RFid



VSE series 1,000 Volt insulated diagonal cutting pliers for copper

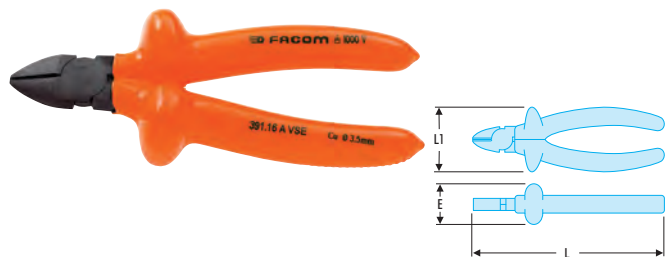

NF ISO 5749, ISO 5749, DIN ISO 5749, ASME B107.500

- Embedded meshing model.
- CU cutting diameter: 3.5 mm.
- Insulation with "safety" colour coding.
- Finish: burnished head.



ED	E [mm]	L [mm]	L1 [mm]	Cu - Ø max [mm ²]	ΔΔ [g]
391.16AVSE	35	165	70	3,5	270

VSE series 1,000 Volt insulated end nippers for hard wire

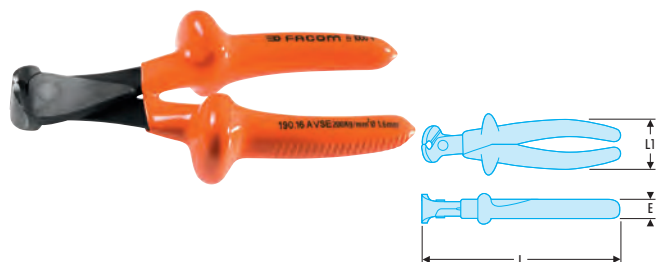

NF ISO 5748, NF EN 60900, ISO 5748, EN 60900, DIN ISO 5748, DIN EN 60900, ASME B107.500

- Tempered cutting edges for hardness above 60 HRC.
- Cutting diameter/200 kg/mm²: 1.6 mm.
- Insulation with "safety" colour coding.
- Finish: burnished head.



ED	E [mm]	L [mm]	L1 [mm]	200 kg/mm ² [Ø mm]	ΔΔ [g]
190.16AVSE	77	165	35	1,6	250

COMBINATION PLIERS

187.AVSE - VSE series 1,000 Volt insulated combination pliers

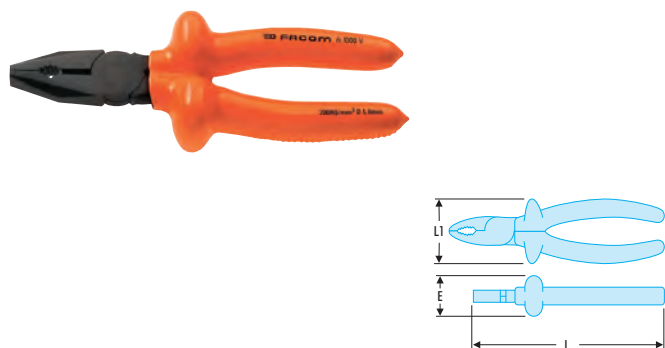

NF ISO 5746, NF EN 60900, ISO 5746, EN 60900, DIN ISO 5746, DIN EN 60900, ASME B107.500

- Tempered pliers for general strength.
- Second treatment on cutting edge for cutting edge hardness above 60 HRC.
- Insulation with "safety" colour coding.
- Finish: burnished head.



ED	E [mm]	L [mm]	L1 [mm]	140 kg/mm ² [Ø mm]	200 kg/mm ² [Ø mm]	Cu - Ø max [mm ²]	ΔΔ [g]
187.16AVSE	35	165	65	2,0	1,6	3,3	265
187.18AVSE	35	185	70	1,8	1,8	3,7	320
187.20AVSE	40	205	70	2,0	2,0	4,0	410

GRIP PLIERS

VSE series 1,000 Volt insulated flat nose pliers

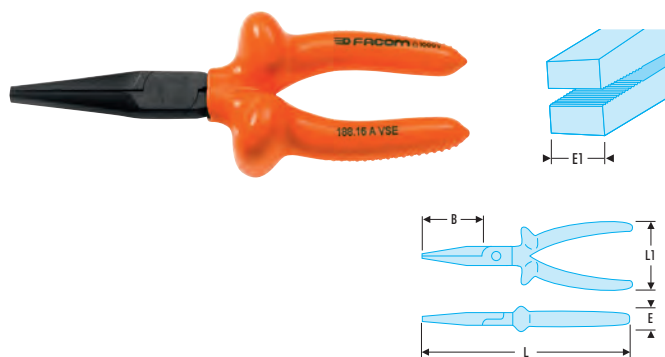

NF ISO 5746, NF EN 60900, ISO 5746, EN 60900, DIN ISO 5746, DIN EN 60900, ASME B107.500

- Serrated nose tips.
- Insulation with "safety" colour coding.
- Finish: burnished head.



ED	B [mm]	E [mm]	E1 [mm]	L [mm]	L1 [mm]	ΔΔ [g]
188.16AVSE	50	37	7	165	60	170

CABLE CUTTER

■ 412.AVSE - VSE series 1,000 Volt insulated copper-alu cable cutter



NF EN 60900, EN 60900, DIN EN 60900

- Particularly efficient for limited size.
- Forged safety stops.
- Insulation with "safety" colour coding.
- Finish: burnished head.



	B [mm]	B1 [mm]	E [mm]	E1 [mm]	L [mm]	L1 [mm]	Cu - Ø max [mm ²]	ΔΔ [g]
412.10AVSE	25	35	10	35	195	80	8	390
412.14AVSE	30	35	13	35	230	80	14	510
412.150AVSE	60	70	16	70	450	155	32	220

■ 414.AVSE - VSE series 1,000 Volt insulated ratchet cable cutter



NF EN 60900, EN 60900, DIN EN 60900

- One-hand cutting.
- No distortion of the cable cut.
- Tempered forged steel blade.
- Insulation with "safety" colour coding.



414.45AVSE

- Cutting dimension: 45 mm.
- Max cutting cross-section copper 300 mm² and alu. 400 mm².
- Copper sector cable: 3x70.
- Alu sector cable: 4x70.

414.52AVSE

- Cutting dimension: 52 mm.
- Max cutting cross-section copper 400 mm².
- Max cutting cross-section HVA: 240 mm².
- LV sector cable: 3*150+70 or 3*240+95.

	B [mm]	E [mm]	L [mm]	ΔΔ [kg]
414.45AVSE	135	42	260	1.0
414.52AVSE	140	37	280	1.0

HACKSAW FRAME

■ SE series 1,000 Volt insulated hacksaw frame



NF E 73-073, NF EN 60900, EN 60900, DIN 6473, DIN EN 60900

- Hacksaw frame for 300 mm blade.
- 2 blade positions.
- Tension by wing nut.
- Supplied with one bimetal blade.
- Dimensions: 470 x 130 x 20 mm.



	ΔΔ [g]
602.AVSE	590

KNIFE

VSE series 1,000 Volt insulated knife

NF EN 60900, EN 60900, DIN EN 60900

- Model with thick, angled, flat end blade.
- Soft bi-material handle.
- Storage case.
- Active blade length: 60 mm.
- Max dimensions: 185 x 52 x 25 mm.



Model	Weight [g]
1820.AVSE	90

OPEN-END WRENCHES

46.AVSE - VSE series 1,000 Volt insulated open end wrenches

NF ISO 4229, NF EN 60900, ISO 4229, EN 60900, DIN 3114, DIN EN 60900

- Insulation with "safety" colour coding.



Model	A [mm]	B [mm]	E [mm]	L [mm]	Weight [g]
46.8AVSE	8	22	8	105	30
46.9AVSE	9	24	9	105	35
46.10AVSE	10	25	9	105	40
46.11AVSE	11	29	10	115	50
46.12AVSE	12	30	10	125	60
46.13AVSE	13	32	11	135	70
46.14AVSE	14	34	11	145	80
46.15AVSE	15	36	11	145	90
46.16AVSE	16	38	12	155	105
46.17AVSE	17	41	12	155	120
46.18AVSE	18	42	12	160	135
46.19AVSE	19	45	12	165	150
46.21AVSE	21	50	14	185	180

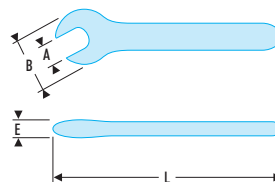

RING WRENCHES

55.AVSE - VSE series 1,000 Volt insulated offset ring wrenches

NF EN 60900, EN 60900, DIN EN 60900

- OGV® profile ring.
- Insulation with "safety" colour coding.



Model	A [mm]	B [mm]	E [mm]	L [mm]	L1 [mm]	Weight [g]
55.8AVSE	8	16	8	150	16	50
55.9AVSE	9	17	9	151	17	55
55.10AVSE	10	19	9	157	17	60
55.11AVSE	11	20	10	160	19	70
55.12AVSE	12	21	11	165	20	100
55.13AVSE	13	23	12	165	20	105
55.14AVSE	14	25	12	180	21	120
55.15AVSE	15	26	12	183	21	130
55.16AVSE	16	27	13	195	26	160
55.17AVSE	17	30	14	198	27	180
55.18AVSE	18	30	14	215	27	200
55.19AVSE	19	32	14	215	27	205
55.21AVSE	21	35	16	245	31	300

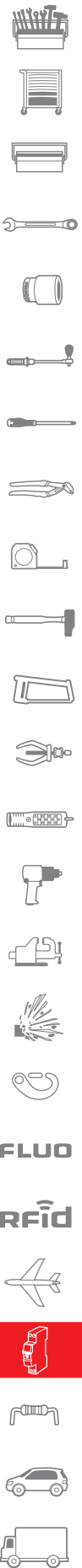
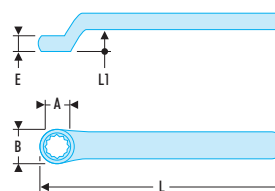

FLUO

RFid



ADJUSTABLE WRENCHES

■ 113.AVSE - VSE series 1,000 Volt insulated adjustable wrenches



NF ISO 6787, NF EN 60900, ISO 6787, EN 60900, DIN EN 60900, ASME B107.100

- Models with finger stop.
- Worm: left-hand rotation.
- Insulation with "safety" colour coding.
- Finish: burnished.

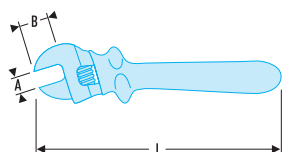

ED	A [mm]	B [mm]	L [mm]	ΔΔ [g]
113.8TAVSE	27	24	210	385
113.10TAVSE	30	29	260	655
113.12TAVSE	34	34	310	950
113.15TAVSE	44	44	385	1900

OFFSET KEYS

■ 83.AVSE - VSE series 1,000 Volt insulated keys

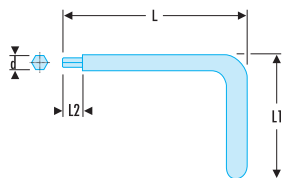
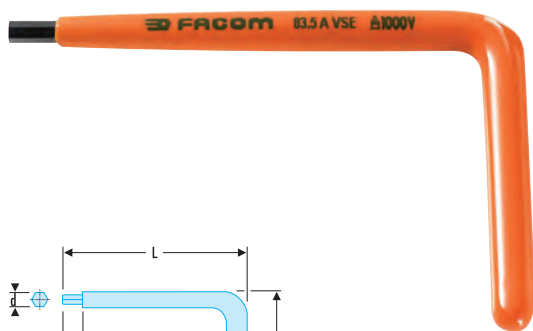

NF ISO 2936, NF EN 60900, ISO 2936, EN 60900, DIN ISO 2936, DIN EN 60900

- Key made in allied steel treated for strength above specifications of standards.
- Insulation with "safety" colour coding.



ED	d [mm]	L [mm]	L1 [mm]	L2 [mm]	ΔΔ [g]
83.3AVSE	3	125	85	12	20
83.4AVSE	4	125	85	12	30
83.5AVSE	5	125	85	12	50
83.6AVSE	6	125	85	12	70
83.8AVSE	8	125	85	12	110
83.10AVSE	10	125	85	12	150
83.12AVSE	12	125	85	12	210

BOX WRENCHES

■ 94T-TL.AVSE - VSE series 1,000 Volt insulated box wrenches

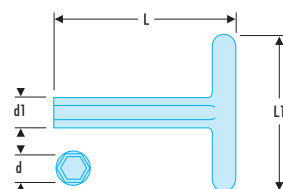

NF EN 60900, EN 60900, DIN EN 60900

- 94T.AVSE: box wrenches length 135 mm.
- 94TL.AVSE: box wrenches length 300 mm.



ED	d [mm]	d1 [mm]	L [mm]	L1 [mm]	ΔΔ [g]
94T.6AVSE	6	13	135	115	150
94T.8AVSE	8	15	135	115	160
94T.10AVSE	10	19	135	115	185
94T.11AVSE	11	23	135	115	185
94T.12AVSE	12	24	135	115	210
94T.13AVSE	13	25	135	115	225
94T.14AVSE	14	26	135	115	240
94TL.10AVSE	10	21	300	205	420
94TL.13AVSE	13	25	300	205	520
94TL.16AVSE	16	30	300	205	800
94TL.17AVSE	17	30	300	205	840
94TL.19AVSE	19	33	300	205	910

SOCKETS 1/4"

FACOM VSE 1,000 VOLT INSULATED RATCHETS AND SOCKETS

A comprehensive range of tools for working on live components

- 1 Comprehensive range of accessories: extensions, T handles, etc.
- 2 Variety of socket lengths.
- 3 Square drives: 1/2", 3/8", 1/4" for overcoming accessibility problems.



1000VOLTS
EN 60900



And complete box sets.

R.AVSE - VSE series 1,000 Volt insulated 6-point 1/4" sockets

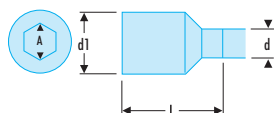

NF ISO 2725-1, NF ISO 1711-1, NF EN EN 60900, ISO 2725-1, ISO 1711-1, EN 60900, DIN 3124, DIN EN 60900, ASME B107.5

- Manual use sockets.
- Drive bit 1/4" - 6.35 mm.

	A [mm]	d [mm]	d1 [mm]	L [mm]	ΔΔ [g]
R.6AVSE	6	22	16	22	10
R.7AVSE	7	22	17	22	16
R.8AVSE	8	22	17	22	16
R.10AVSE	10	22	18	22	20
R.12AVSE	12	22	22	22	30



RT.AVSE - VSE series 1,000 Volt insulated 6-point 1/4" bit sockets

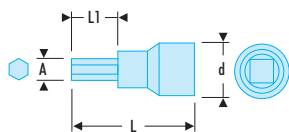

NF EN 60900, EN 60900, DIN EN 60900

- Manual use sockets.
- Drive bit 1/4" - 6.35 mm.

	A [mm]	d [mm]	L [mm]	L1 [mm]	ΔΔ [g]
RT.4AVSE	4	22	37	11	20
RT.5AVSE	5	22	37	13	20
RT.6AVSE	6	22	37	14	20



RATCHETS AND ACCESSORIES 1/4"

VSE series 1,000 Volt insulated 1/4" ratchet



NF ISO 3315, NF EN 60900, ISO 3315, EN 60900, DIN 3122, DIN EN 60900, ASME B107.10

- Drive bit 1/4" - 6.35 mm.
- Sockets and accessories held by spring ball (9 N).
- Insulation grip with "safety" colour coding.
- Dimensions: 125 x 45 x 35 mm.

	ΔΔ [g]
R.151AVSE	140

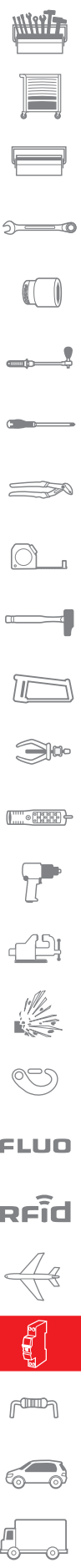

VSE series 1,000 Volt insulated 1/4" extension



NF ISO 3316, NF EN 60900, ISO 3316, EN 60900, DIN 3123, DIN EN 60900, ASME B107.10

- Drive bit 1/4" - 6.35 mm.



🔧	d [mm]	L [mm]	ΔΔ [g]
R.210AVSE	16,6	116	65

Set of 10 VSE series 1,000 Volt insulated tools



- Including:
 - 5 sockets 6, 7, 8, 10, 12 mm.
 - 3 6-point bit sockets 4, 5, 6 mm.
 - 1 ratchet R.151AVSE.
 - 1 extension R.210AVSE.
- Case dimensions: 322 x 136 x 53 mm.



🔧	H [mm]	L [mm]	ΔΔ [g]
R.400AVSE	53	322	650

SOCKETS 3/8"

J.AVSE - VSE series 1,000 Volt insulated 12-point 3/8" sockets

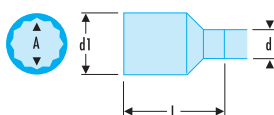

NF ISO 2725-1, NF ISO 1711-1, NF EN 60900, ISO 2725-1, ISO 1711-1, EN 60900, DIN 3124, DIN EN 60900, ASME B107.5

- Manual use sockets.
- Drive bit 3/8" - 9.53 mm.
- OGV® profile.

🔧	A [mm]	d [mm]	d1 [mm]	L [mm]	ΔΔ [g]
J.8AVSE	8	18	17	43	30
J.10AVSE	10	18	18	43	34
J.11AVSE	11	18	20	43	35
J.12AVSE	12	18	21	46	35
J.13AVSE	13	18	22	46	45
J.14AVSE	14	18	23	46	45
J.15AVSE	15	18	25	46	45
J.16AVSE	16	18	25	46	45
J.17AVSE	17	18	27	46	48
J.18AVSE	18	18	27	46	66

LONG REACH SOCKETS 3/8"

J.LAVSE - VSE series 1,000 Volt insulated long 12-point 3/8" sockets

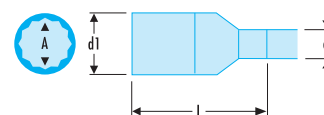

NF ISO 2725-1, NF ISO 1711-1, NF EN 60900, ISO 2725-1, ISO 1711-1, EN 60900, DIN 3124, DIN EN 60900, ASME B107.5

- Manual use sockets.
- Drive bit 3/8" - 9.53 mm.
- OGV® profile.

🔧	A [mm]	d [mm]	d1 [mm]	L [mm]	ΔΔ [g]
J.8LAVSE	8	18	19	63	66
J.13LAVSE	13	18	23	63	75
J.14LAVSE	14	18	23	63	98
J.16LAVSE	16	18	25	69	147
J.17LAVSE	17	18	27	76	147
J.18LAVSE	18	18	28	76	157
J.19LAVSE	19	18	29	76	166

BIT SOCKETS 3/8"

■ JT.AVSE - VSE series 1,000 Volt insulated male 6-point 3/8" bit sockets

NF EN 60900, EN 60900, DIN EN 60900

- Manual use sockets.
- Drive bit 3/8" - 9.53 mm.



Icon	A [mm]	d [mm]	L [mm]	L1 [mm]	ΔΔ [g]
JT.4AVSE	4	18	66	10	43
JT.5AVSE	5	18	66	10	43
JT.8AVSE	8	18	66	10	56

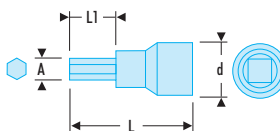

RATCHETS AND ACCESSORIES 3/8"

■ VSE series 1,000 Volt insulated 3/8" ratchet

NF ISO 3315, NF EN 60900, ISO 3315, EN 60900, DIN 3122, DIN EN 60900, ASME B107.10

- Drive bit 3/8" - 9.53 mm.
- Sockets and accessories held by spring ball set (16 N).
- Insulation grip with "safety" colour coding.
- Dimensions: 180 x 50 x 48 mm.



Icon	ΔΔ [g]
J.151AVSE	250

■ VSE series 1,000 Volt insulated 3/8" handle

NF EN 60900, EN 60900, DIN EN 60900, ASME B107.10

- Handle with drive bit 3/8" - 9.53 mm.
- Sockets and accessories held by spring ball set (16 N).
- Insulation grip with "safety" colour coding.
- Dimensions: 205 x 165 x 35 mm.



Icon	ΔΔ [g]
J.121AVSE	380



J.AVSE - VSE series 1,000 Volt insulated 3/8" extensions



NF ISO 3316, NF EN 60900, ISO 3316, EN 60900, DIN 3123, DIN EN 60900, ASME B107.10

- Drive bit 3/8" - 9.53 mm.



Model	d [mm]	L [mm]	ΔΔ [g]
J.210AVSE	17	150	150
J.215AVSE	17	260	290

Set of 9 VSE series 1,000 Volt insulated tools



- Including:
 - 6 12-point sockets 8, 10, 11, 12, 13, 14 mm.
 - 1 ratchet J.151AVSE.
 - 2 extensions J.210AVSE, J.215AVSE.
- Dimensions: 390 x 160 x 68 mm.



Model	H [mm]	L [mm]	ΔΔ [kg]
J.400AVSE	68	390	1.7

SOCKET SETS AND ACCESSORIES 3/8"

Set of 17 VSE series 1,000 Volt insulated tools



- Including:
 - 9 12-point sockets 8, 10, 11, 12, 13, 14, 15, 17, 19 mm.
 - 5 6-point bit sockets 4, 5, 6, 7, 8 mm.
 - 1 ratchet J.151AVSE.
 - 1 handle J.121AVSE.
 - 1 extension J.210AVSE.
- Dimensions: 345 x 280 x 65 mm.



Model	H [mm]	L [mm]	ΔΔ [kg]
J.401AVSE	65	345	2.3

SOCKETS 1/2"

S.AVSE - VSE series 1,000 Volt insulated 12-point 1/2" sockets



NF ISO 2725-1, NF ISO 1711-1, NF EN EN 60900, ISO 2725-1, ISO 1711-1, EN 60900, DIN 3124, DIN EN 60900, ASME B107.5

- Manual use sockets.
- Drive bit 1/2" - 12.7 mm.
- OGV® profile.



Model	A [mm]	d [mm]	d1 [mm]	L [mm]	ΔΔ [g]
S.8AVSE	8	22	17	52	70
S.9AVSE	9	22	18	52	70
S.10AVSE	10	22	19	52	75
S.11AVSE	11	22	20	52	75
S.12AVSE	12	22	22	52	75
S.13AVSE	13	22	23	52	75
S.14AVSE	14	22	24	52	80
S.17AVSE	17	22	28	52	90
S.19AVSE	19	22	32	52	95
S.21AVSE	21	22	33	52	130
S.22AVSE	22	22	34	52	145

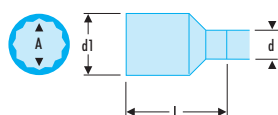

LONG REACH SOCKETS 1/2"

■ S.LAVSE - VSE series 1,000 Volt insulated long 12-point 1/2" sockets

NF ISO 2725-1, NF ISO 1711-1, NF EN EN 60900, ISO 2725-1, ISO 1711-1, EN 60900, DIN 3124, DIN EN 60900, ASME B107.5

- Manual use sockets.
- Drive bit 1/2" - 12.7 mm.
- OGV® profile.



FACOM	A [mm]	d [mm]	d1 [mm]	L [mm]	ΔΔ [g]
S.12LAVSE	12	22	22	77	125
S.13LAVSE	13	22	23	77	135
S.14LAVSE	14	22	24	77	135
S.16LAVSE	16	22	27	77	150
S.17LAVSE	17	22	28	77	161
S.18LAVSE	18	22	29	77	167
S.19LAVSE	19	22	32	77	180

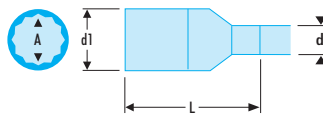

BIT SOCKETS 1/2"

■ ST.AVSE - VSE series 1,000 Volt insulated male 6-point 1/2" bit sockets

NF EN 60900, EN 60900, DIN EN 60900

- Manual use sockets.
- Drive bit 1/2" - 12.7 mm.



FACOM	d [mm]	d1 [mm]	L [mm]	L1 [mm]	ΔΔ [g]
ST.8AVSE	8	22	70	10	90
ST.10AVSE	10	22	70	12	90
ST.12AVSE	12	22	92	12	145
ST.14AVSE	14	22	92	17	150
ST.17AVSE	17	22	92	19	175

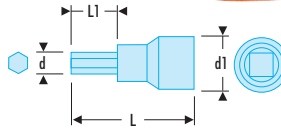

RATCHETS AND ACCESSORIES 1/2"

■ VSE series 1,000 Volt insulated 1/2" ratchet

NF ISO 3315, NF EN 60900, ISO 3315, EN 60900, DIN 3122, DIN EN 60900, ASME B107.10

- Drive bit 1/2" - 12.7 mm.
- Sockets and accessories held by spring ball set (38 N).
- Insulation grip with "safety" colour coding.
- Dimensions: 265 x 55 x 70 mm.



FACOM	ΔΔ [g]
S.151AVSE	580

■ VSE series 1,000 Volt insulated 1/2" handle

NF EN 60900, EN 60900, DIN EN 60900

- Handle with drive bit 1/2" - 12.7 mm.
- Sockets and accessories held by spring ball set (38 N).
- Insulation grip with "safety" colour coding.
- Dimensions: 210 x 165 x 25 mm.



FACOM	ΔΔ [g]
S.121AVSE	520

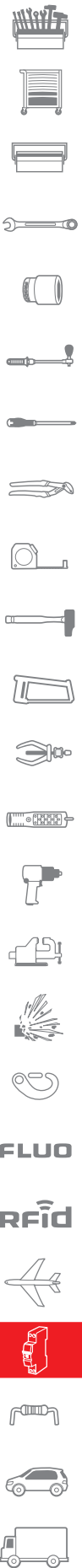

■ S.AVSE - VSE series 1,000 Volt insulated 1/2" extensions



NF ISO 3316, NF EN 60900, ISO 3316, EN 60900, DIN 3123, DIN EN 60900, ASME B107.10

- Drive bit 1/2" - 12.7 mm.



FACOM	d [mm]	L [mm]	ΔΔ [g]
S.210AVSE	22	145	250
S.215AVSE	22	265	470

SOCKET SETS AND ACCESSORIES 1/2"

■ Set of 12 VSE series 1,000 Volt insulated tools



NF EN 60900, EN 60900, DIN EN 60900

- Including:
 - 9 12-point sockets 8, 9, 10, 11, 12, 13, 14, 17, 19 mm.
 - 1 ratchet S.151AVSE.
 - Extensions S.210AVSE and S.215AVSE .
- Dimensions: 390 x 160 x 68 mm.



FACOM	H [mm]	L [mm]	ΔΔ [kg]
S.400AVSE	68	390	2.5

■ Set of 17 series 1,000 Volt insulated tools



NF EN 60900, EN 60900, DIN EN 60900

- Including:
 - 9 12-point sockets 8, 9, 10, 11, 12, 13, 14, 17, 19 mm.
 - 5 bit sockets 8, 10, 12, 14, 17 mm.
 - 1 ratchet S.151AVSE.
 - Handle S.121AVSE.
 - S.210AVSE Extension.
- Dimensions: 345 x 280 x 65 mm.



FACOM	H [mm]	L [mm]	ΔΔ [kg]
S.401AVSE	65	345	3.4

TORQUE WRENCH

VSE series 1,000 Volt insulated torque wrench

NF EN ISO 6789, NF EN 60900, ISO 6789, EN 60900,
DIN EN ISO 6789, DIN EN 60900

- Safe precision.
- Adjustment system locking ring.
- Wrench compliant with the ISO EN 6789 standard for torque control.
- Accuracy + or - 4 % for 5,000 cycles min.
- Automatic trigger and reset.
- Re-calibratable wrench: typical procedure for torque wrenches.
- Drive bit 3/8".
- Capacity 10 to 50 N.m.
- One-way wrench.
- Wrench compliant with the EN 60900 standard for insulated tools.
- Protection up to 1,000 Volt AC and 1500 Volt direct.
- Wrench checked at dielectric test per unit on the manufacturing line.
- Wrench supplied with inspection report.



REF	L [mm]	ΔΔ [kg]
J.306-50VSE	380	1.3

BC.VSE - INSULATED GLOVES

BC.VSE - Insulated gloves

NF EN 60903, EN 60903, DIN EN 60903

- Natural latex gloves, AZM classification:
 - Resistance to acid: A.
 - Resistance to ozone: Z.
 - High mechanical strength: M.
- Length: 360 mm.
- Supplied in anti-UV opaque bag.



REF	E [mm]	Class	Size [mm]	Voltage/Volt	ΔΔ [g]
BC.80VSE	0,5	00	9 (B)	500	150
BC.81VSE	0,5	00	10 (C)	500	150
BC.90VSE	1,0	0	9 (B)	1000	150
BC.91VSE	1,0	0	10 (C)	1000	150

BC.VSE - SAFETY OVERGLOVES

BC.VSE - Safety overgloves

NF EN 60903, EN 60903, DIN EN 60903

- Silicon coated leather gloves protecting from mechanical risks.
- Used to protect latex insulated gloves.
- Physical and mechanical grade as per standard EN 388: 2, 1, 2, 1.
 - Abrasion: 2.
 - Cuts: 1.
 - Tears: 2.
 - Perforation: 1.



REF	Size [mm]	ΔΔ [g]
BC.109VSE	9 (B)	160
BC.110VSE	10 (C)	160



BC.VSE - INSULATED MATS

■ BC.VSE - Insulated mats



NF C 18-421

- Rubber mat for insulation by cladding grounds.
- Thickness: 3.2 mm.
- Hardness: 60 DIDC.
- Dimensions:
 - BC.20VSE: 1 x 0,6 m.
 - BC.21VSE: 1 x 1 m.



ED	L x l [m]	ΔΔ [kg]
BC.20VSE	1 x 0,6	2,5
BC.21VSE	1 x 1,0	4,2

INSULATED PLIERS

■ Insulated plier



- Powerful clamping resin plier for assembly of insulating mats.
- Fitted with a suspension hook.
- Max opening: 40 mm.



ED	L [mm]	ΔΔ [g]
BC.25VSE	155	70

INSULATED TOOL SETS

■ 2180B.VSE - 10-piece set of 1,000 Volt insulated tools



- Basic set for shop electrical maintenance.
- Supplied in leather bag BV.100.
- Dimensions: 350 x 120 x 120 mm.
- Weight: 2.025 kg.



ED	Qtys	Set Description
1820.AVSE	1	1,000 Volt insulated knife
187.18AVSE	1	1,000 Volt insulated combination pliers
189.17AVSE	1	1,000 Volt insulated round nose pliers
194.17AVSE	1	1,000 Volt insulated strippers
391.16AVSE	1	1,000 Volt insulated diagonal cutters for copper
AT4X100VE	1	1,000 Volt insulated screwdriver for slotted heads 4x100 mm
AT5.5x150VE	1	1,000 Volt slotted head screwdrivers 5.5x150 mm
ATP1X100VE	1	1,000 Volt screwdrivers for Phillips® PH 1 head
BC.90VSE	1	Low temperature insulating gloves S9
BV.100	1	Compact leather bag

■ 2187C.VSE - 32-piece set of 1,000 Volt insulated tools

- For electrical equipment installers.
 - Supplied in leather wallet BV.7A.
 - Dimensions: 445 x 330 x 185 mm.
- Weight: 8.500 kg.



Item Code	Qty	Set Description
113.10AVSE	1	1,000 Volt insulated adjustable wrench 30 mm
187.18AVSE	1	1,000 Volt insulated combination pliers
188.16AVSE	1	1,000 Volt insulated flat nose pliers
189.17AVSE	1	1,000 Volt insulated round nose pliers
194.17AVSE	1	1,000 Volt insulated strippers
391.16AVSE	1	1,000 Volt insulated copper diagonal cutters
412.14AVSE	1	1,000 Volt copper/alu cable cutter 14 mm
46.10AVSE	1	1,000 Volt insulated open-end wrench 10 mm
46.11AVSE	1	1,000 Volt insulated open-end wrench 11 mm
46.12AVSE	1	1,000 Volt insulated open-end wrench 12 mm
46.13AVSE	1	1,000 Volt insulated open-end wrench 13 mm
46.14AVSE	1	1,000 Volt insulated open-end wrench 14 mm
46.17AVSE	1	1,000 Volt insulated open-end wrench 17 mm
46.19AVSE	1	1,000 Volt insulated open-end wrench 19 mm
46.8AVSE	1	1,000 Volt insulated open-end wrench 8 mm
701B	1	Multifunction tester

Item Code	Qty	Set Description
83.3AVSE	1	1,000 Volt insulated keys 3 mm
83.4AVSE	1	1,000 Volt insulated keys 4 mm
83.6AVSE	1	1,000 Volt insulated keys 6 mm
AT3.5x100VE	1	1,000 Volt insulated slotted head screwdrivers 3.5x100 mm
AT4X100VE	1	1,000 Volt insulated screwdriver for slotted heads 4x100 mm
AT5.5x150VE	1	1,000 Volt slotted head screwdrivers 5.5x150 mm
AT6.5x150VE	1	1,000 Volt slotted head screwdrivers 6.5x150 mm
AT8X150VE	1	1,000 Volt insulated screwdriver for slotted heads 8x150 mm
ATPOX75VE	1	1,000 Volt screwdrivers for Phillips® PH 0 head
ATP1X100VE	1	1,000 Volt screwdrivers for Phillips® PH 1 head
ATP2X125VE	1	1,000 Volt screwdrivers for Phillips® PH 0 head
AV.HT1C	1	Voltage tester screwdriver 90 to 480 Volts
BC.109VSE	1	Safety overgloves S9
BC.90VSE	1	Low temperature insulating gloves S9
BV.7A	1	Leather fold-down front case
R.400AVSE	1	10-piece 1/4" insulated tool set

■ **2184C.VSE** - 41-piece set of 1,000 Volt insulated tools

- For electrical equipment shops, worksites.
 - Supplied in leather case BV.5A.
 - Dimensions: 425 x 215 x 320 mm.
- Weight: 14.130 kg.



Icon	Qtys	Set Description
	1	1,000 Volt insulated knife
	1	1,000 Volt insulated combination pliers
	1	1,000 Volt insulated flat nose pliers
	1	1,000 Volt insulated round nose pliers
	1	1,000 Volt insulated cutters for hard wire
	1	1,000 Volt insulated cutters for hard wire
	1	1,000 Volt insulated strippers
	1	1,000 Volt insulated ratchet cable cutter 45 mm
	1	1,000 Volt insulated open-end wrench 10 mm
	1	1,000 Volt insulated open-end wrench 12 mm
	1	1,000 Volt insulated open-end wrench 13 mm
	1	1,000 Volt insulated open-end wrench 14 mm
	1	1,000 Volt insulated open-end wrench 17 mm
	1	1,000 Volt insulated open-end wrench 19 mm
	1	1,000 Volt insulated open-end wrench 21 mm
	1	Multifunction tester
	1	1,000 Volt insulated keys 3 mm

Icon	Qtys	Set Description
	1	1,000 Volt insulated keys 4 mm
	1	1,000 Volt insulated keys 6 mm
	1	1,000 Volt insulated box wrench 10 mm
	1	1,000 Volt insulated box wrench 13 mm
	1	1,000 Volt insulated box wrench 8 mm
	1	1,000 Volt insulated slotted head screwdrivers 10x200 mm
	1	1,000 Volt insulated slotted head screwdrivers 3.5x100 mm
	1	1,000 Volt insulated screwdriver for slotted heads 4x100 mm
	1	1,000 Volt slotted head screwdrivers 5.5x150 mm
	1	1,000 Volt slotted head screwdrivers 6.5x150 mm
	1	1,000 Volt insulated screwdriver for slotted heads 8x150 mm
	1	1,000 Volt screwdrivers for Pozidriv® PZ 1 head
	1	1,000 Volt screwdrivers for Pozidriv® PZ 2 head
	1	1,000 Volt screwdrivers for Phillips® PH 1 head
	1	1,000 Volt screwdrivers for Phillips® PH 0 head
	1	Insulating mat 1 m x 0.6 m
	1	Low temperature insulating gloves S9
	1	Leather drawer case
	1	Synthetic folding rule 2 m

FLUO

RFid

