



THE ALIGNMENT WORK HORSE

Designed for the independent workshop to provide core alignment functions quickly and easily

INTRODUCING THE **V2280/V2260** PROFESSIONAL WHEEL ALIGNER

JohnBean™

V2280 V2260

THE ALIGNMENT WORK HORSE

Designed for the independent workshop to provide core alignment functions quickly and easily



V2280/V2260 robust and reliable, makes your job faster and easier

Easy to use

01

- Software designed together with technicians from the ground up for maximum clarity and accessibility. Useful features always one click away
- Intelligent, predictive alignment flows for the selected vehicle model helps the technician
- Compensate, Warn & Alert lets you perform your work fast with professional results
- Robust proprietary operating system, not based on Windows, for hassle-free operation
- Lightweight components for improved ergonomics and less strain on the technician
- The new AC100 wheel clamp is 20% lighter than the previous version
- The new clamp fits 11-22" rims without adapters and allows clamping without removing hubcaps
- Two or four wheel alignment capability

Fast to use

02

- Quick start-up of alignment from the home screen:
 - Improved vehicle selection process with model search
 - Alignment history: quick search for Vehicle Registration number and Customer
- All information about the selected vehicle on one page
- Video Speed Camera technology for a faster and more responsive alignment system
 - Rolling Compensation time reduced 35% compared to previous models
 - Intelligent shorter procedure for caster swing: 40% faster than previous models
- Motorized automatic camera beam saves walking and adjustment time for technician
- Patented VODI™ system - the camera's lights guide the technician through the alignment
- EZ-TOE - allows adjustment of toe at any steering angle for easy access
- Quickly switch the language on the home screen and when printing

01

EASY TO USE

- Software designed together with technicians around the core functions
- Work with confidence using the compensate, warn & alert system

02

FAST TO USE

- Video speed camera system
- Intelligent workflows
- Automatic tracking camera beam

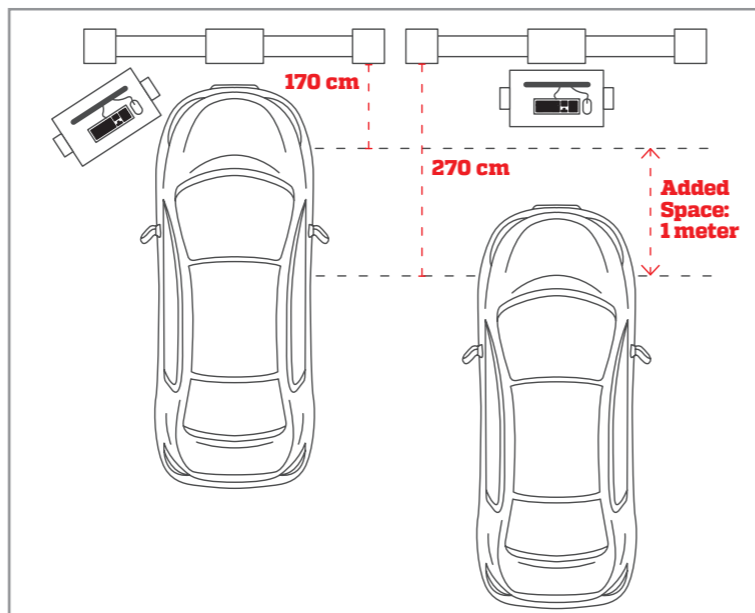

03

FLEXIBLE

- Multiple beam configuration
- Cabinet position independent from camera beam
- Use mobility kit to combine cabinet and camera system into one mobile unit

Short Bay

Only 1,70 m between cameras and turntables

- The smallest footprint for a 3D aligner
- Accommodates 6 meter overall length service bays and work areas
- The cabinet can be moved independently
- Optimize your workshop space
- Save 1 meter of space without compromising accuracy and speed

Automatic Lift Tracking

We use the world's most advanced camera system

The V2280 cameras follow the height of the vehicle avoiding the need to adjust the aligner while moving the lift. Alignment readings are ready in less than two minutes!

Flexible



03

- Camera beam and Cabinet connections of up to 50 m apart with a standard ethernet cable
- Independent wall power for cabinet and beam
- Online connectivity automatically downloads specifications and software updates
- Cloud-based printing option: retrieve and print your reports from any internet connected PC or mobile device

Interactive software

Intelligent and predictive alignment workflow

Avoid guessing with a rapid and reliable system for detecting problems and damage:

-  **Compensate:** measurement ok and compensated with no notification
-  **Warn:** wheel imperfections are compensated and user is warned
-  **Alert:** critical errors are detected and corrective actions are displayed

Easy, intuitive workflow



01

SELECT VEHICLE

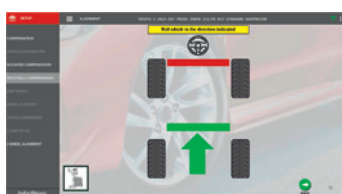

02

MEASURE



03

ADJUST



04

PRINT REPORT

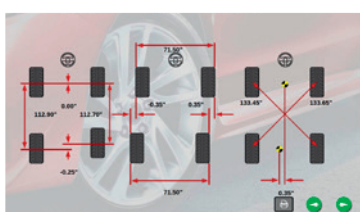
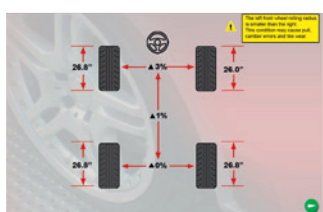

Advanced Dimensions

Rolling Radius and Cross Diagonals

Chassis data as diagonals, track width and wheelbase indicate collision damage. Rolling Radius measurement and tyre size mismatch are common contributors to pull problems.

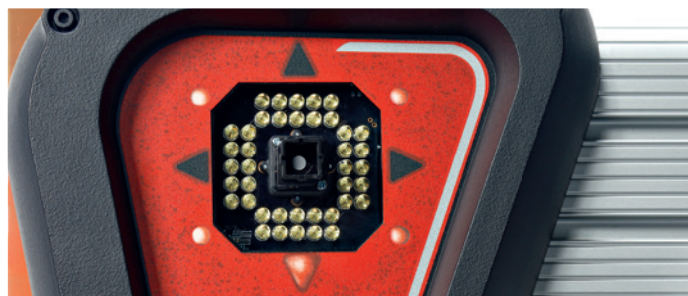

VODI™

Video speed camera technology and patented VODI™ system.

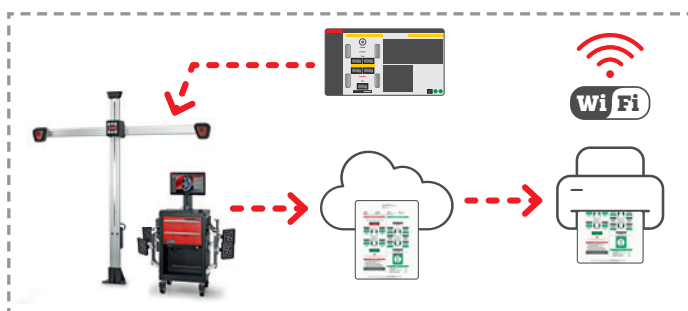

Connect it and get more

- With our favourable specs subscription plans you are always updated with the latest vehicle models
- Wireless remote display (tablet) supported



Manual lift

The position of the V2260 cameras can be adjusted manually, allowing the operator to work at the preferred lift height.

Configurations

V2280 Alignment system with motorized automatic tracking camera beam, mobile cabinet with integrated wheel clamp holders.

V2260 Alignment systems with manual movable camera beam, mobile cabinet with integrated clamp holders. Optional V2260 configuration: Only camera beam and cabinet without any support.



JohnBean™

www.johnbean.com/en/distributor

Part of the machines is illustrated with optional extras which are available at extra cost. Technical modifications reserved. Cod. 2010 007 - 10/2020



Snap-on Total Shop Solutions offers a wide range of garage equipment solutions for workshops, garages, car dealers and tyre shops, thanks to the specific solutions provided by its portfolio of premium brands.